

AluRack ASSEMBLY INSTRUCTIONS

AluRack Fully Assembled Illustration

Tools required for installation:

A electric drill
6.5mm drill bit
Anti corrosion treatment
Junior hacksaw
5mm Allen wrench
11mm Socket
13mm Socket
11mm Wrench
13mm Wrench

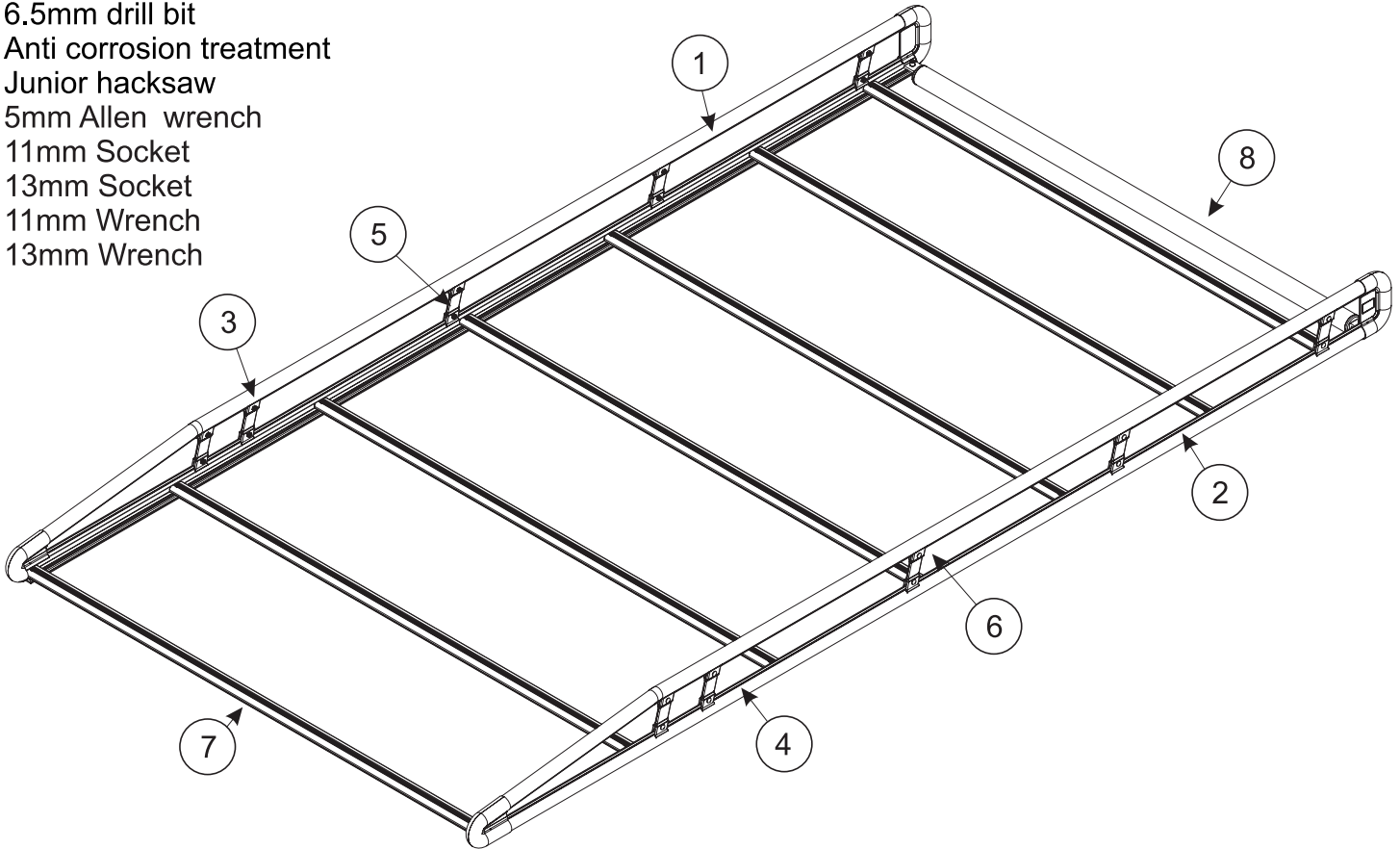

Content:

Page 2 : Packaging List.
Page 3-5 : Rack Assembly.
Page 6 : Roller (optional) Assembly.
Page 7-8 : Rail mounting.
Page 9-10 : Mounting Brackets.
Page 11 : Replacement Parts.
Page 12 : Complete Assembly Photos





PACKAGING LIST

AluRack Model: (See your shipping details)

ITEM QTY DESCRIPTION

① 1 .. Length : 2500mm 

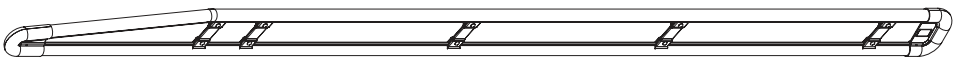
② 1 .. Length : 2500mm 

③ _6_ .. Length : 1500mm 

④ 4 .. M02 :

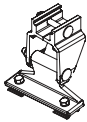

⑤ 2 .. C21 :



OPTIONAL:

⑥ 1 .. Length :C.... mm 



AluRack Assembly

Step 1 : Assemble front Crossbar.

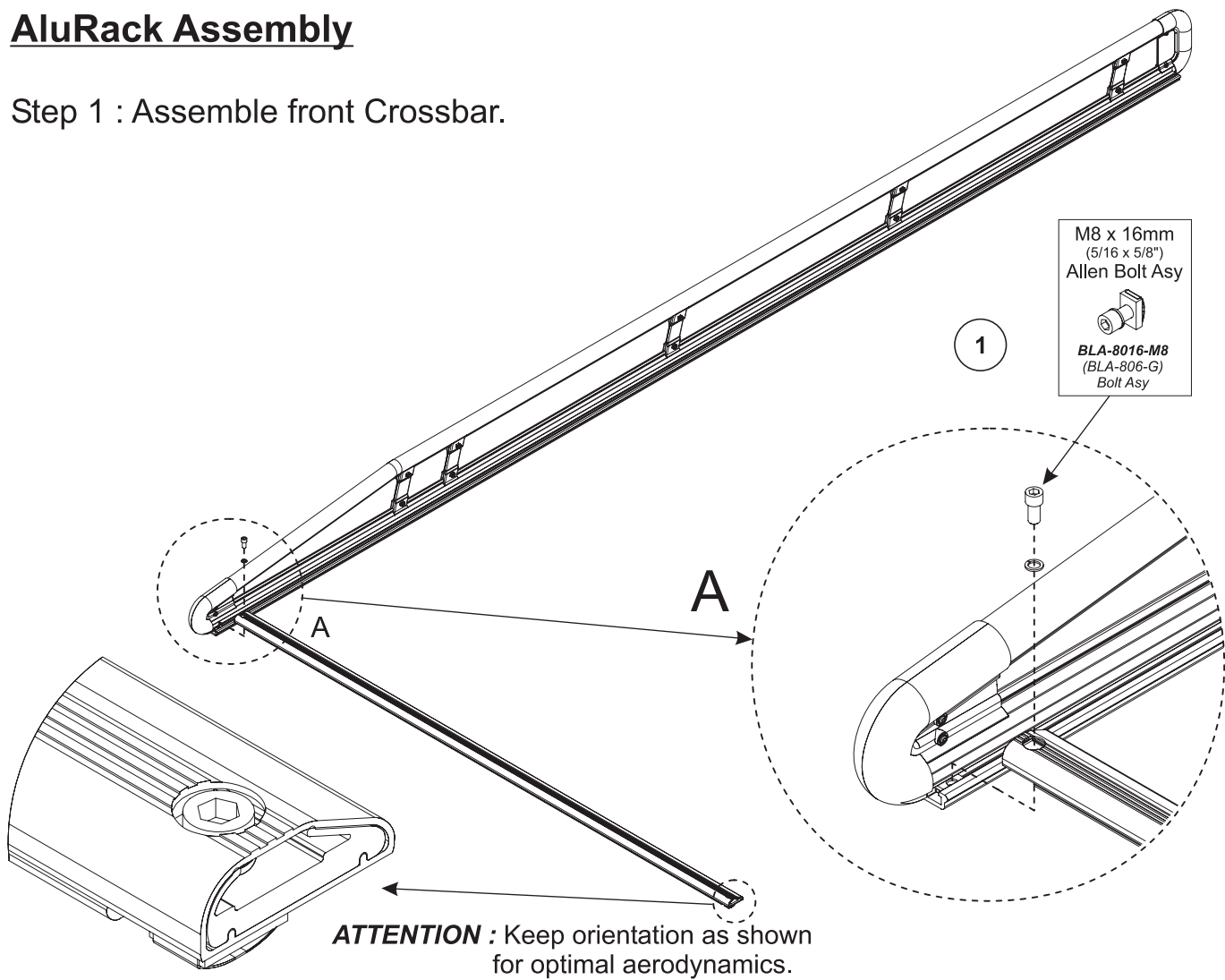

AluRack Assembly

Step 1 : Result

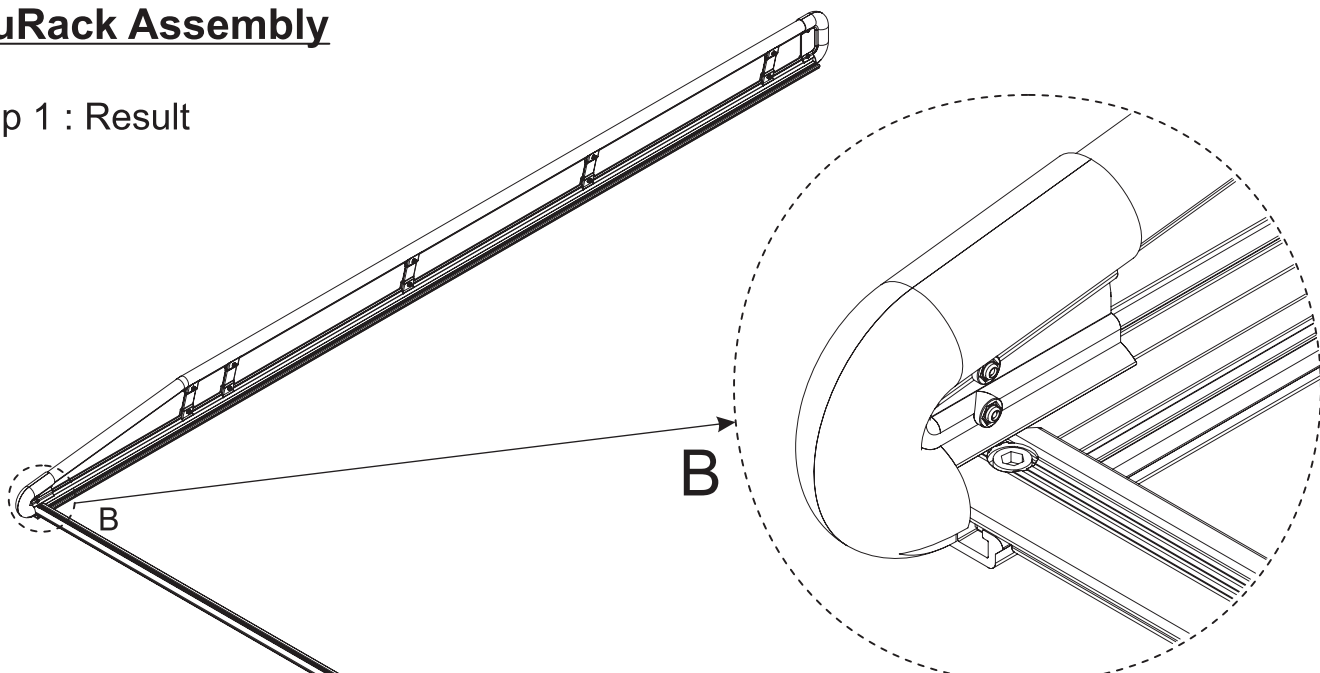

AluRack Assembly

Step 2 : Repeat step 1 and
assemble remaining Crossbars.

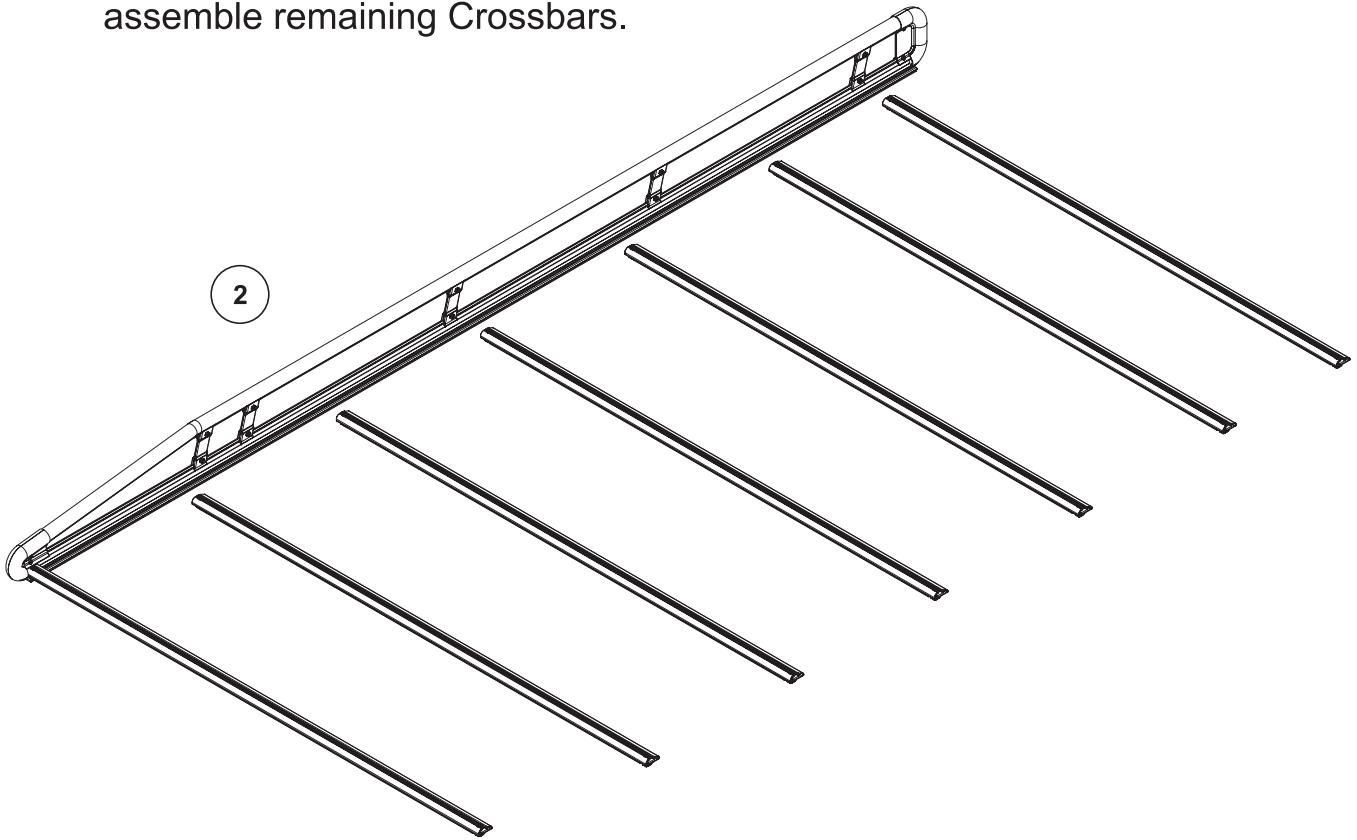

AluRack Assembly

Step 2 : Result

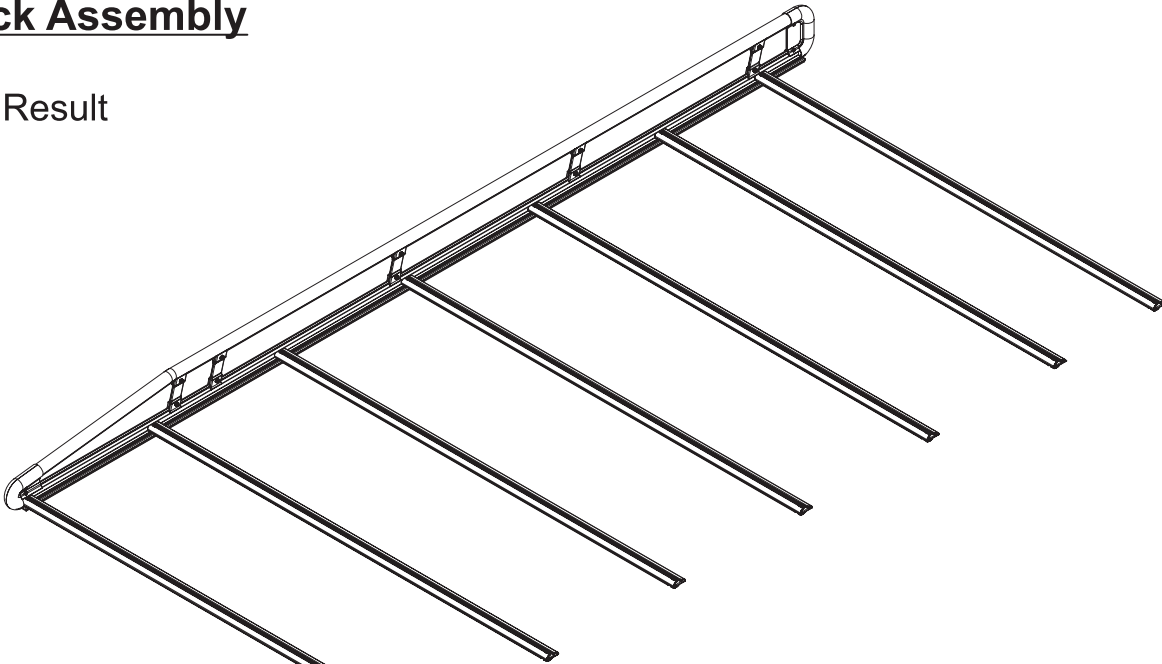

AluRack Assembly

Step 3 : Assemble second Side Rail.

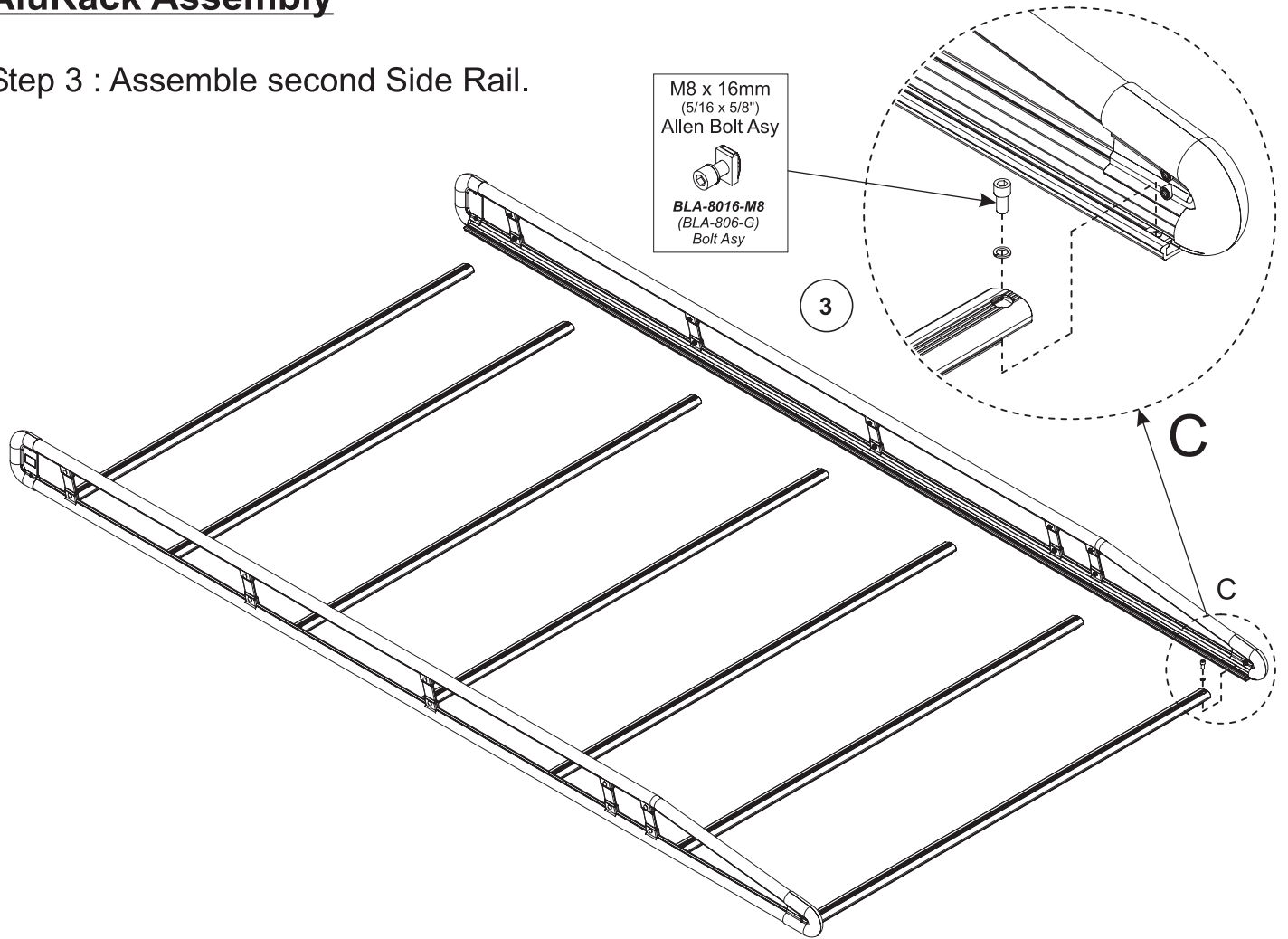

AluRack Assembly

Step 3 : Result

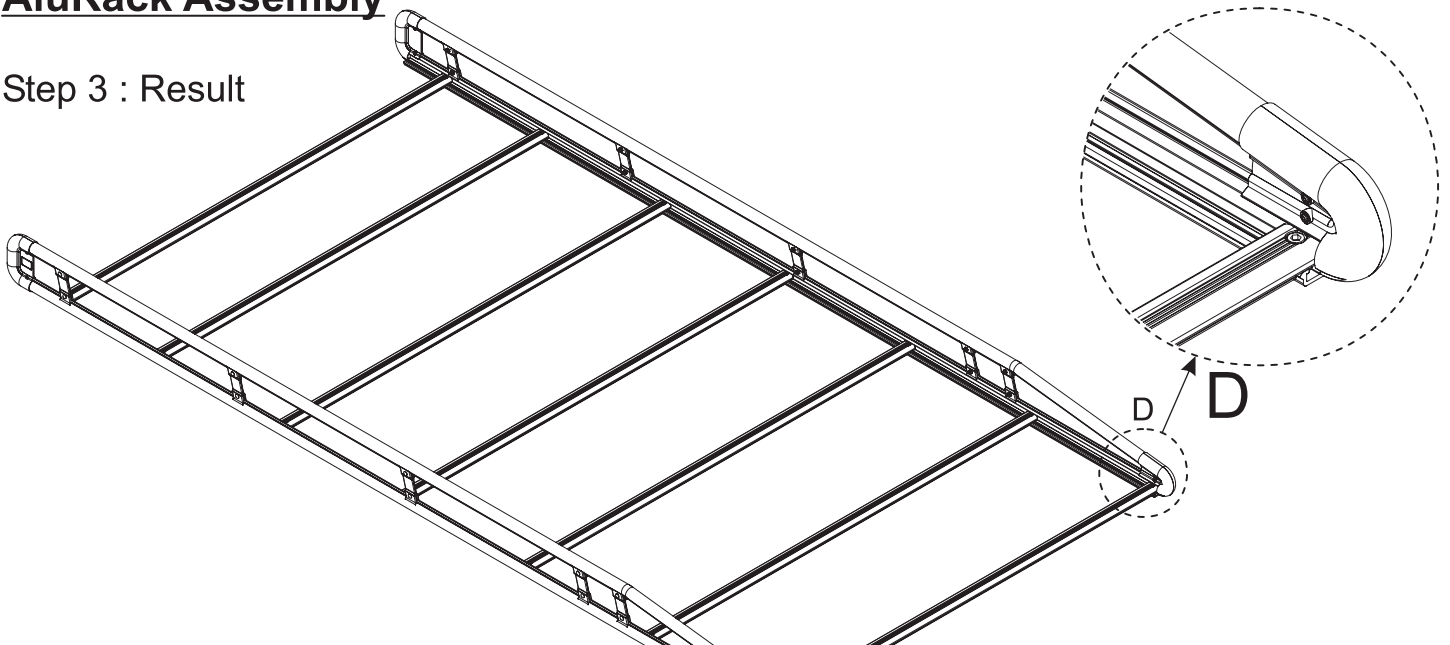

AluRack Assembly

Step 4 : Assemble Roller (Optional).

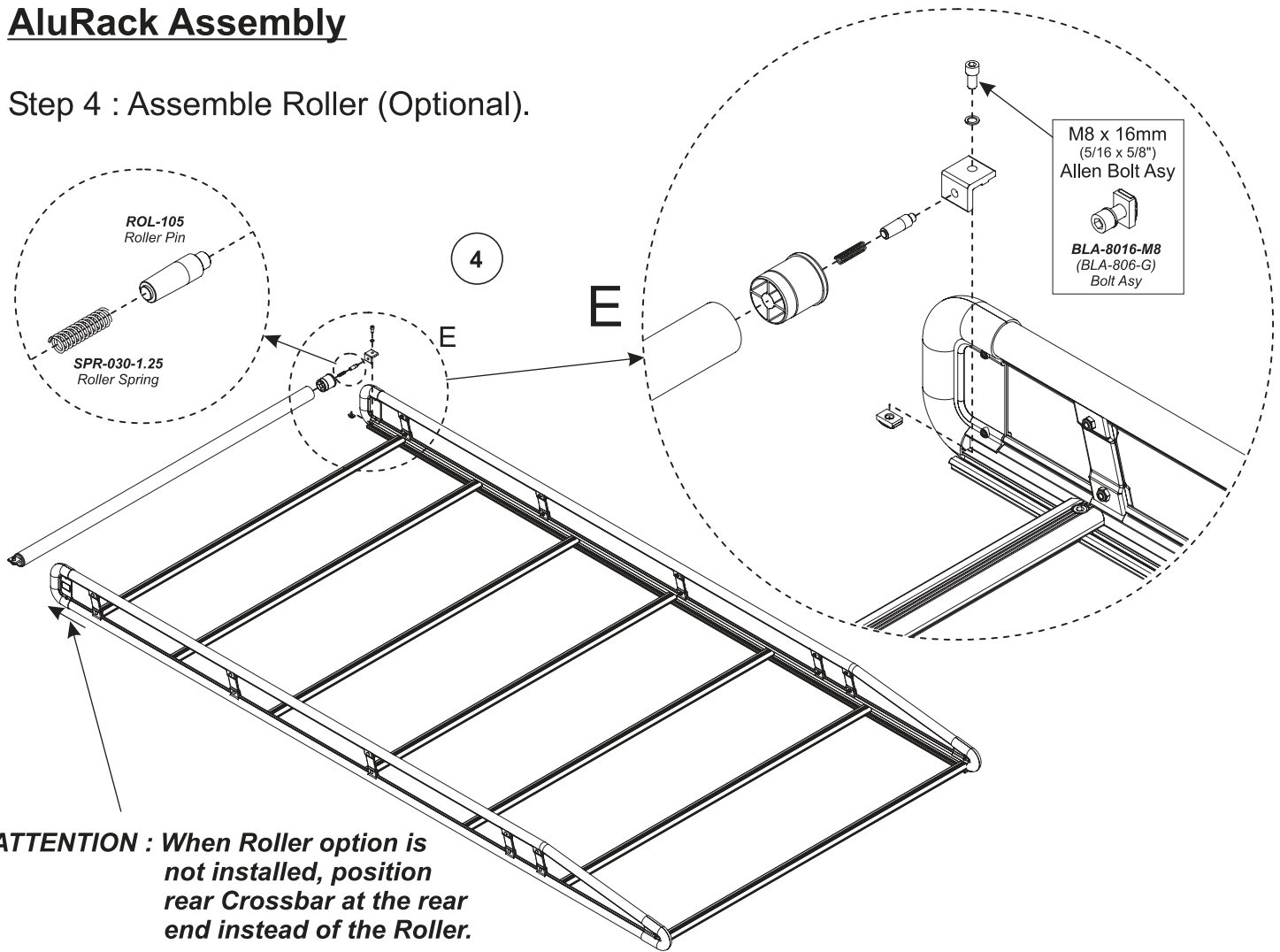

AluRack Assembly

Step 4 : Result

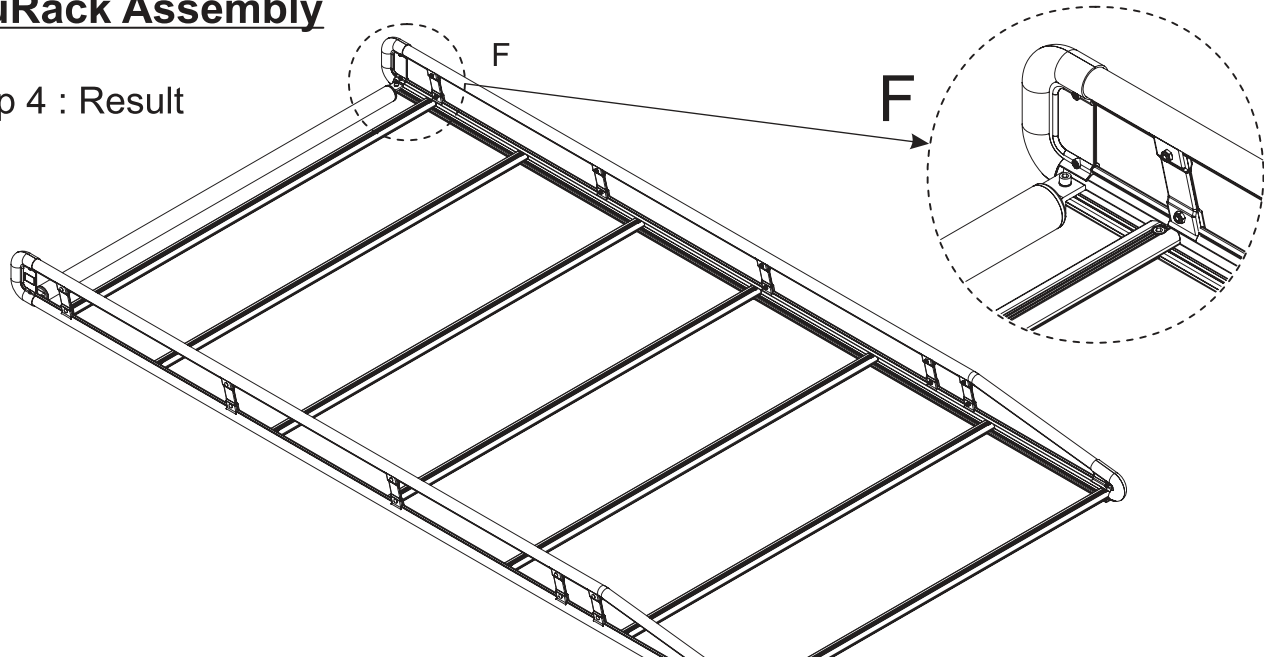

AluRack Assembly

Step 5 : Remove the black Strip/Moulding off the roof. (You will need to cut this strip to close the gap between windshield and the front end of the rail, see following steps).

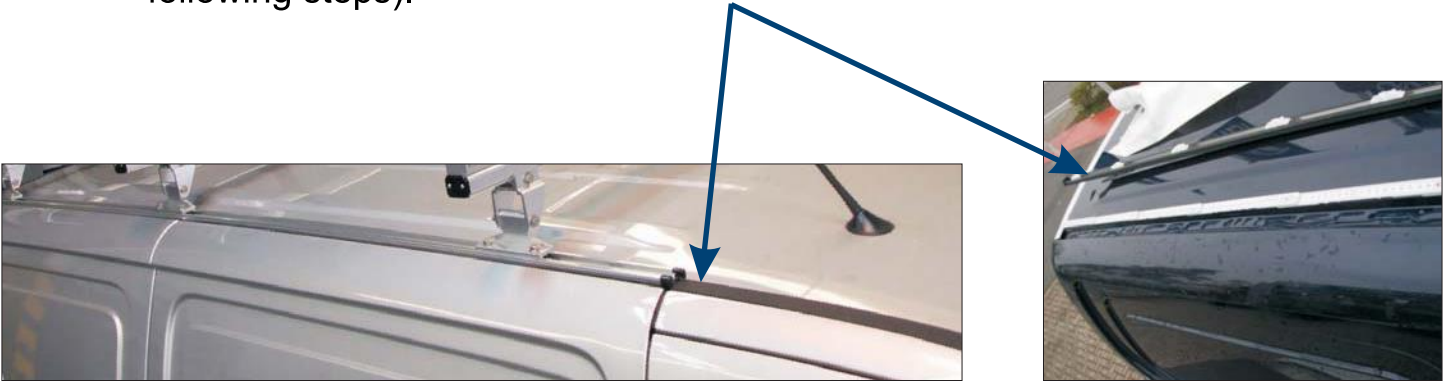

AluRack Assembly

Step 6 : Lay the Rail on the roof, starting with the end marked "Rear" at the rear end of the roof, in front of the rear door.

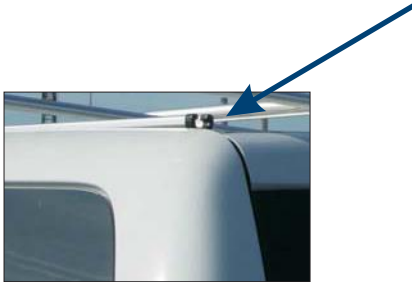

NOTE : Installing AluRack on i800 people carrier requires lowering of the head-liner to be able to bolt the rail down.

AluRack Assembly

Step 7 : Mark the roof for drilling at the Rail holes. Remove the Rails and drill 6.5mm holes. Blow the chips away. (Use Eye Protection!). Treat holes with anti corrosion treatment. Enhance water tight and corrosion prevention by coating hole area with Silicone before bolts assembly.

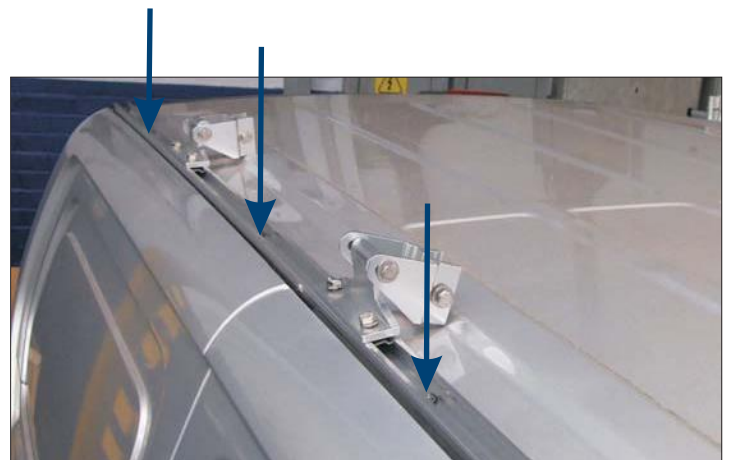

AluRack Assembly

Step 8 : Mount AC21 as shown.

AC21

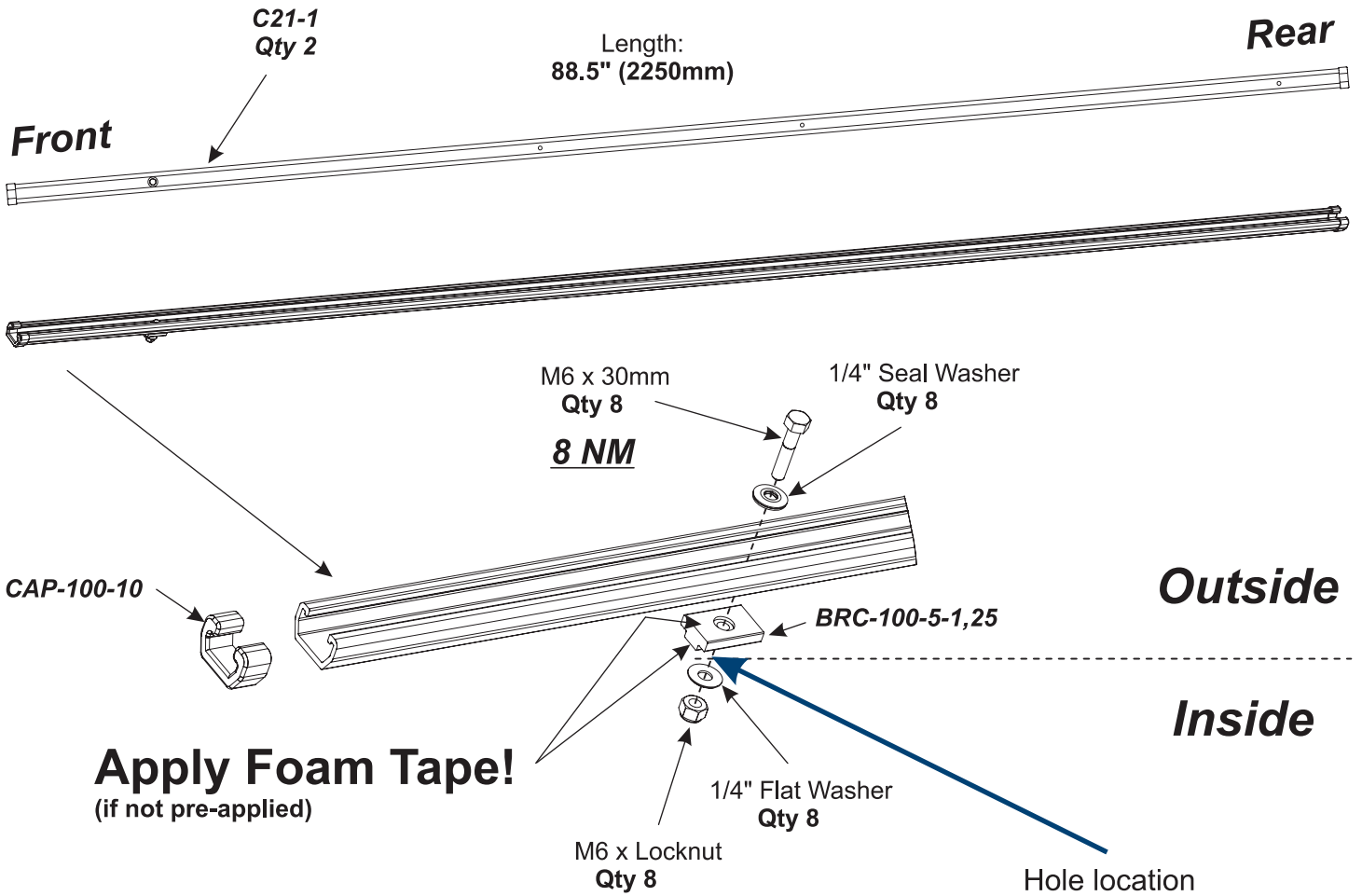

AluRack Assembly

Step 9 : Measure length from front Moulding position to the Rail. Cut Moulding and reattach as shown:



AluRack Assembly

Step 10 : Mount AM02 as shown.

AM02

4 x

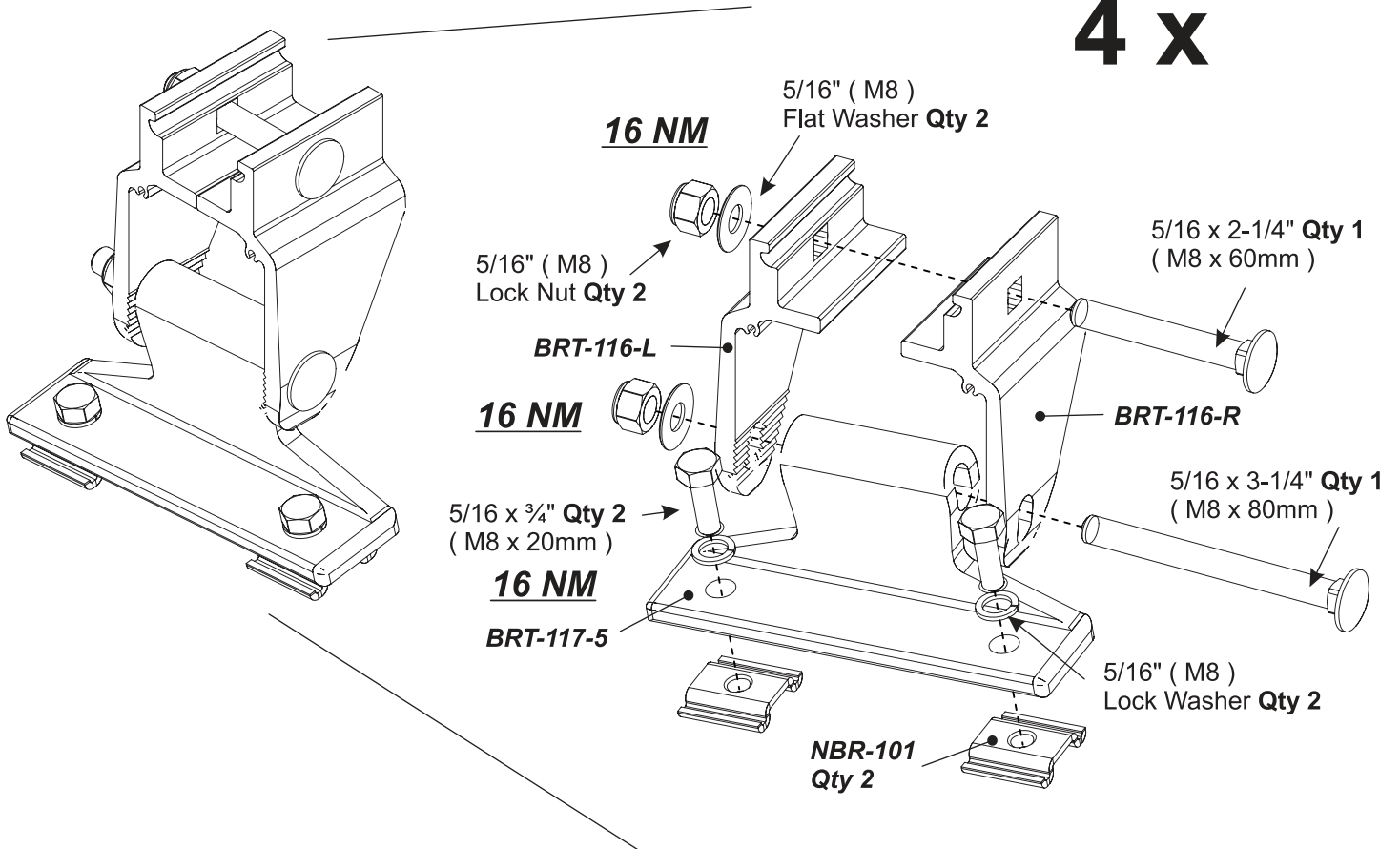

AluRack Assembly

Step 10 : Result



AluRack Assembly

Step 11 : Mount AluRack as shown.

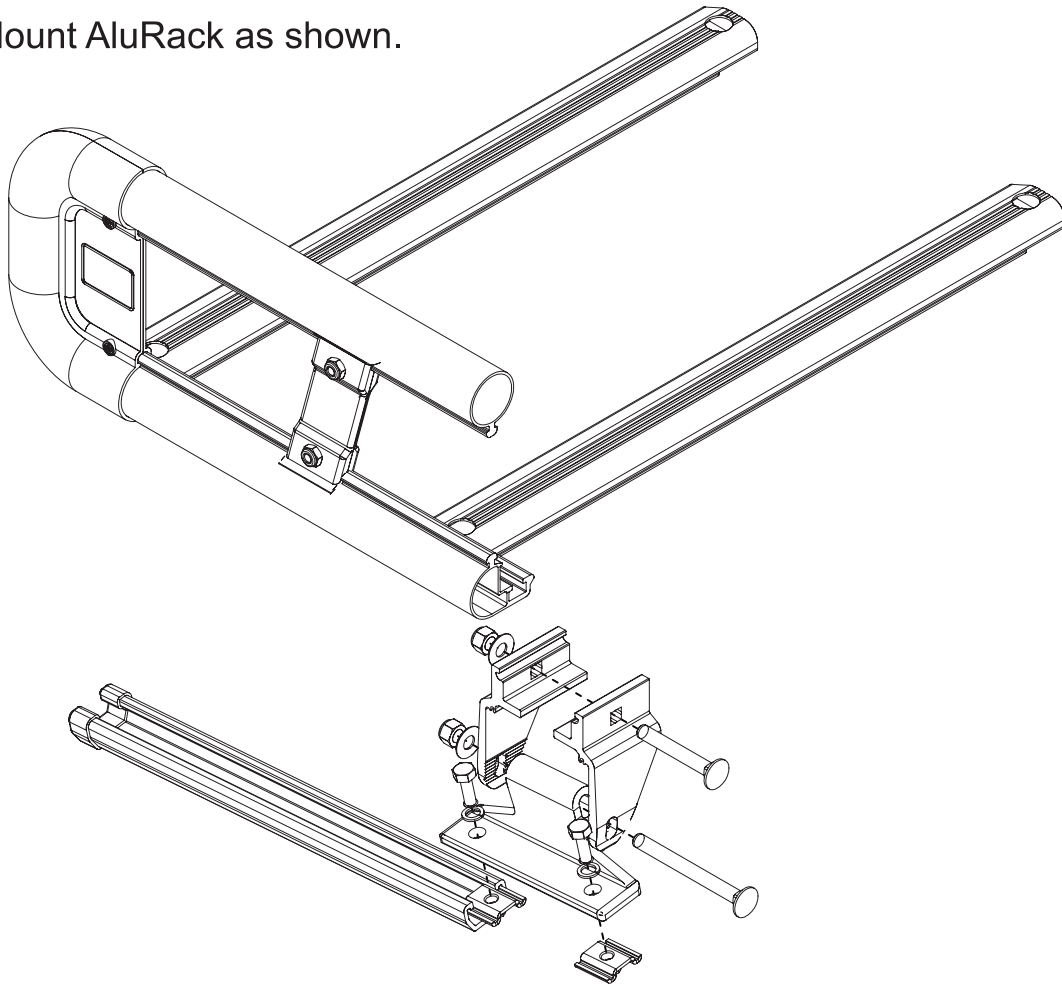

AluRack Assembly

Step 11 : Result

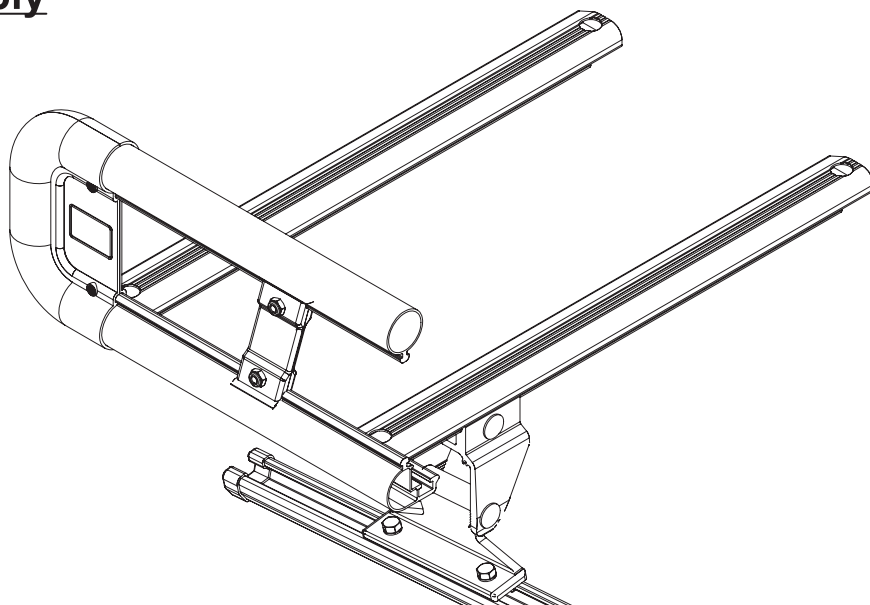

Replacement Parts :

Replacement Parts: AluRack Rail, RH. Part No. **AR-H-R** (2500mm)

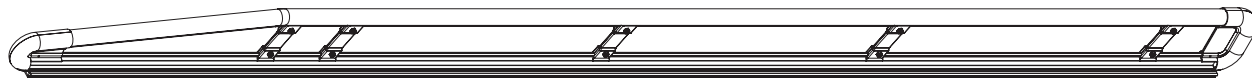

Replacement Parts: AluRack Rail, LH. Part No. **AR-H-L** (2500mm)

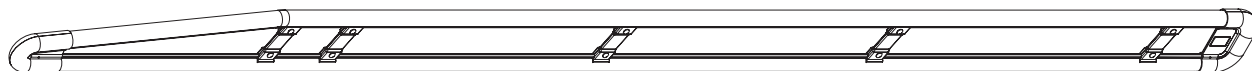

Replacement Parts: AluRack Crossbar, Part No. **AR-6** (1500mm)



Replacement Parts: AluRack Roller, Part No. **ARL-6** (1500mm)



