

**PDE**  
PRIME DESIGN EUROPE

**AXC**

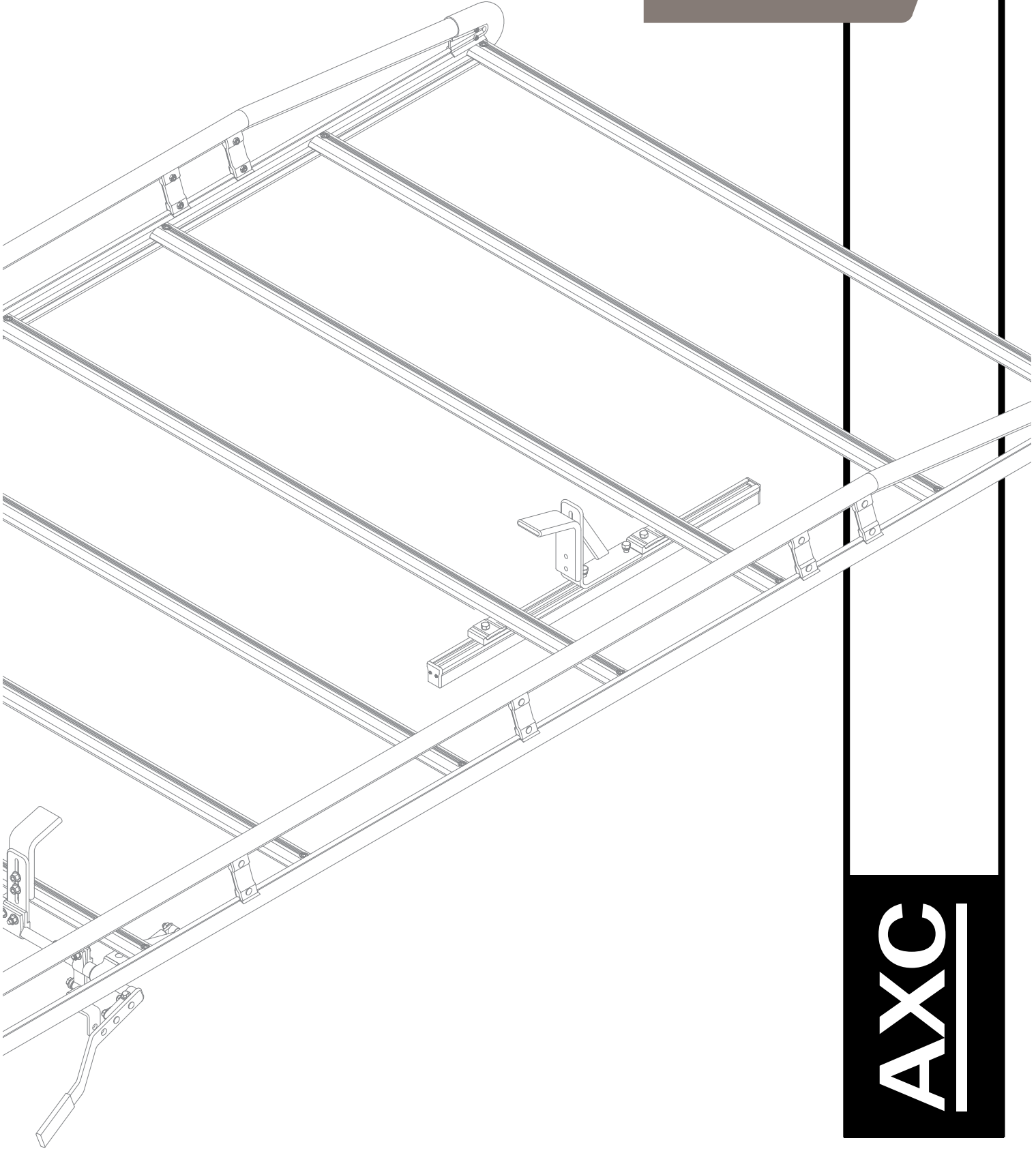

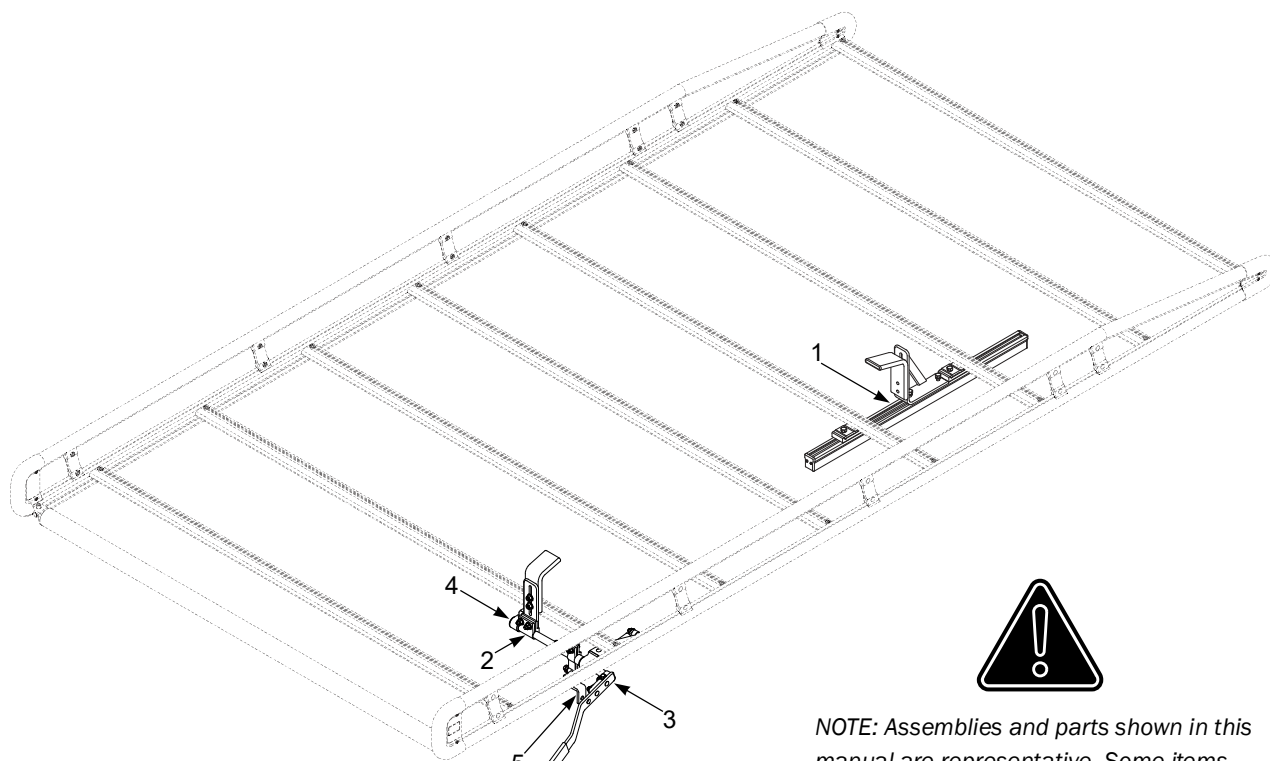

**NOTE:** Assemblies and parts shown in this manual are representative. Some items may appear differently than actual parts, assemblies, or components received.

## TABLE OF CONTENTS

Page 3-4 .....	Packaging Checklist
Page 5 .....	Right Hand S-Clamp Assembly Illustration
Page 6.....	Applying Anti-Seize to Pre-Assembled Rear S-Clamp Assembly
Page 7.....	Pre-setting The Rear S-Clamp Hook
Page 8 .....	Rear S-Clamp Assembly Installation
Page 9.....	S-Clamp Rear Clamp Installation
Page 10 .....	S-Clamp Handle Assembly Installation
Page 11 .....	S-Clamp Final Assembly
Page 12-13 .....	S-Clamp Lock Clamp Installation
Page 14-15 .....	Front S-Clamp Assembly Installation
Page 16-17.....	Final Assembly-Connecting Bar Assembly
Page 17.....	Notes

1.—S-Clamp Adjustable Front Hook Assy.....(Qty 1)

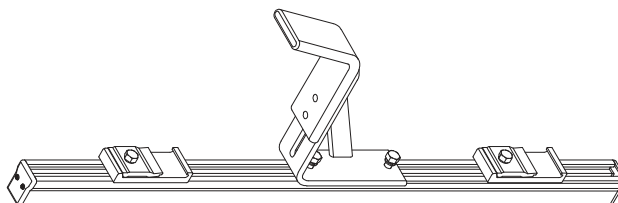
☐

2.—S-Clamp, 152mm, RH ..... (Qty 1)

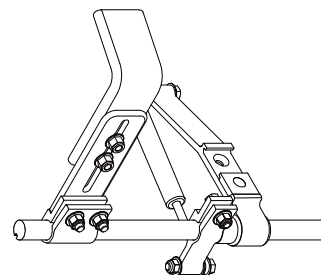
☐

3.—S-Clamp Handle Assy, RH ..... (Qty 1)

☐

4.—Rear Clamp Assy, AluRack ..... (Qty 1)

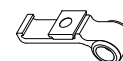
☐

5.—Side Mounting Lock Bracket, AluRack..... (Qty 1)

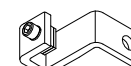
☐

**HKT-201 (Qty 1)**

6.1—5/16" Hex Head Bolt Caps..... (Qty 7)

☐

6.2—5/16" Hex Head Nut Caps ..... (Qty 7)

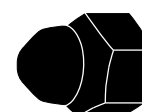
☐

HKT-201 Cont. (Qty 1)

6.3—Anti-Seize Compound ..... (Qty 1)

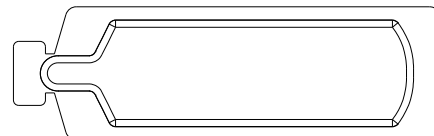

PACKAGING CHECKLIST CONTINUED

**AXC**

Packed By: \_\_\_\_\_ Date: \_\_\_\_ / \_\_\_\_ / \_\_\_\_

Inspected By: \_\_\_\_\_ Date: \_\_\_\_ / \_\_\_\_ / \_\_\_\_

## RIGHT HAND S-CLAMP OVERVIEW

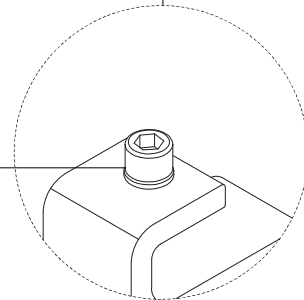
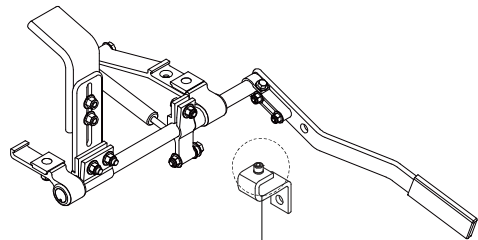
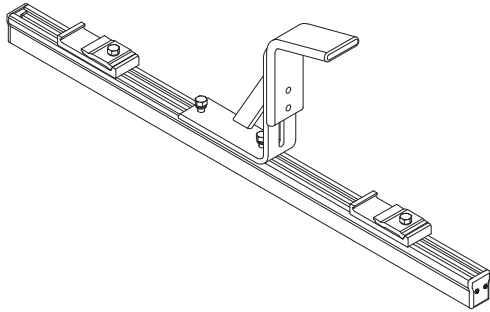

**STEPS 1 –2:**  
**APPLYING ANTI-SEIZE COMPOUND TO**  
**PREASSEMBLED REAR CLAMP ASSEMBLY**

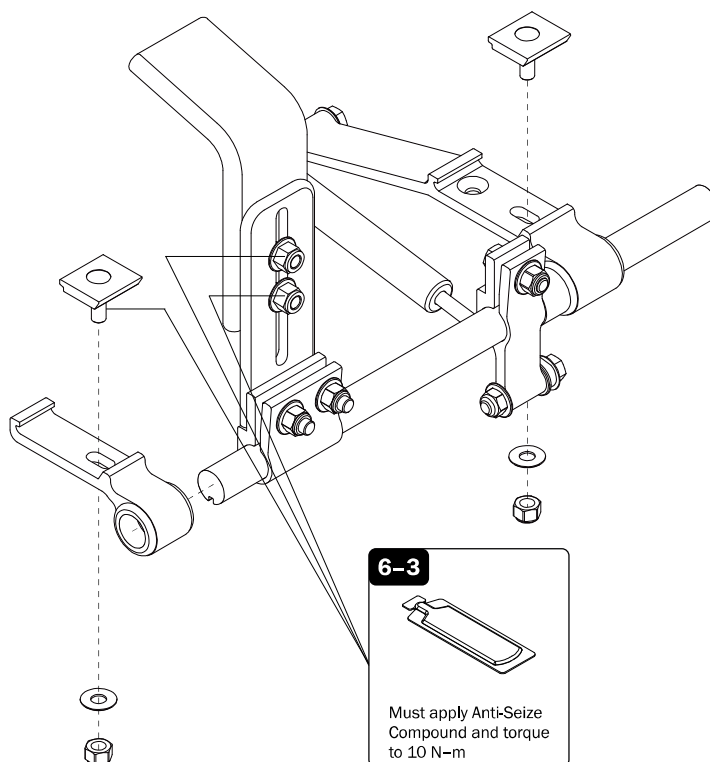

**STEPS 1 –2:**  
**ANTI-SEIZE COMPOUND APPLICATION**  
**RESULTS**

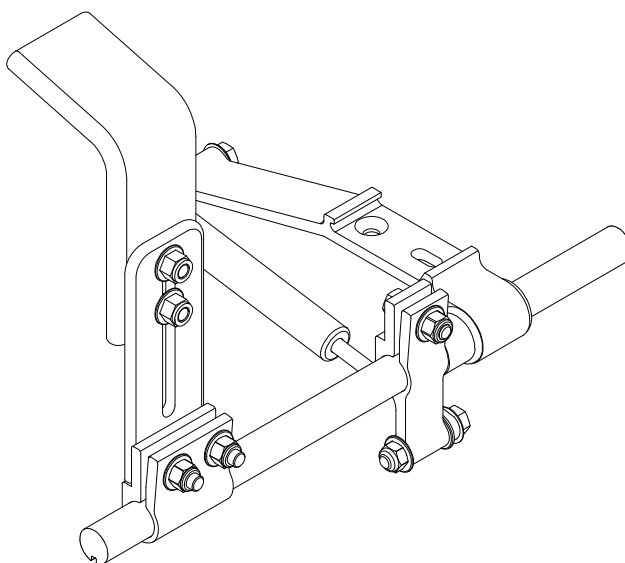

**STEPS 3 –4:**  
**PRESETTING THE S-CLAMP 105°**  
**ADJUSTABLE REAR CLAMP HOOK.**

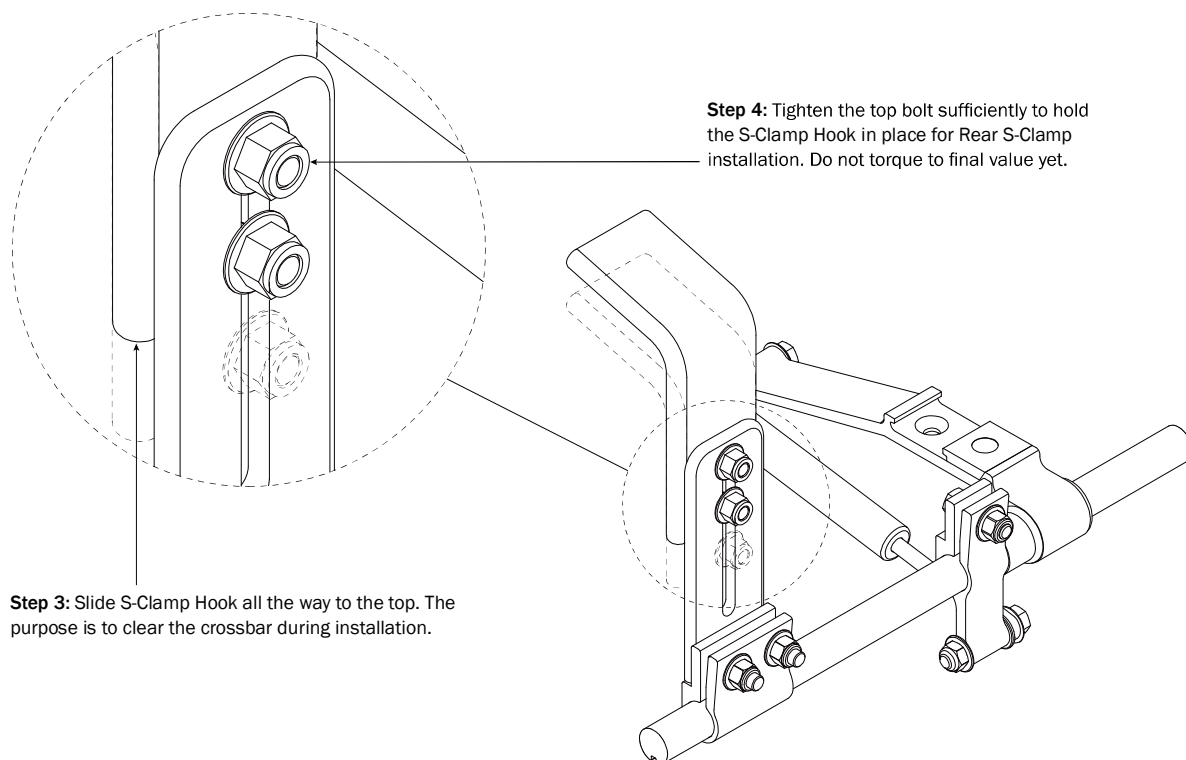

**STEPS 3 –4:**  
**BUSHING INSERTION RESULTS**

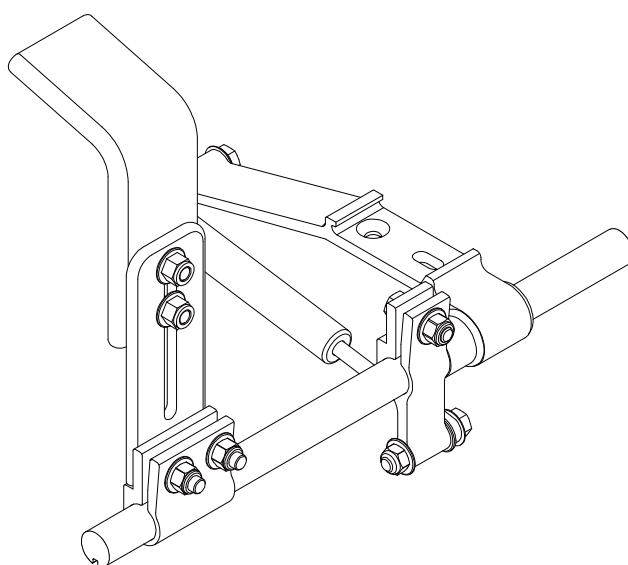

**STEPS 5 –6:**  
**ATTACHING THE REAR S-CLAMP**  
**ASSEMBLY TO THE CROSSBAR**

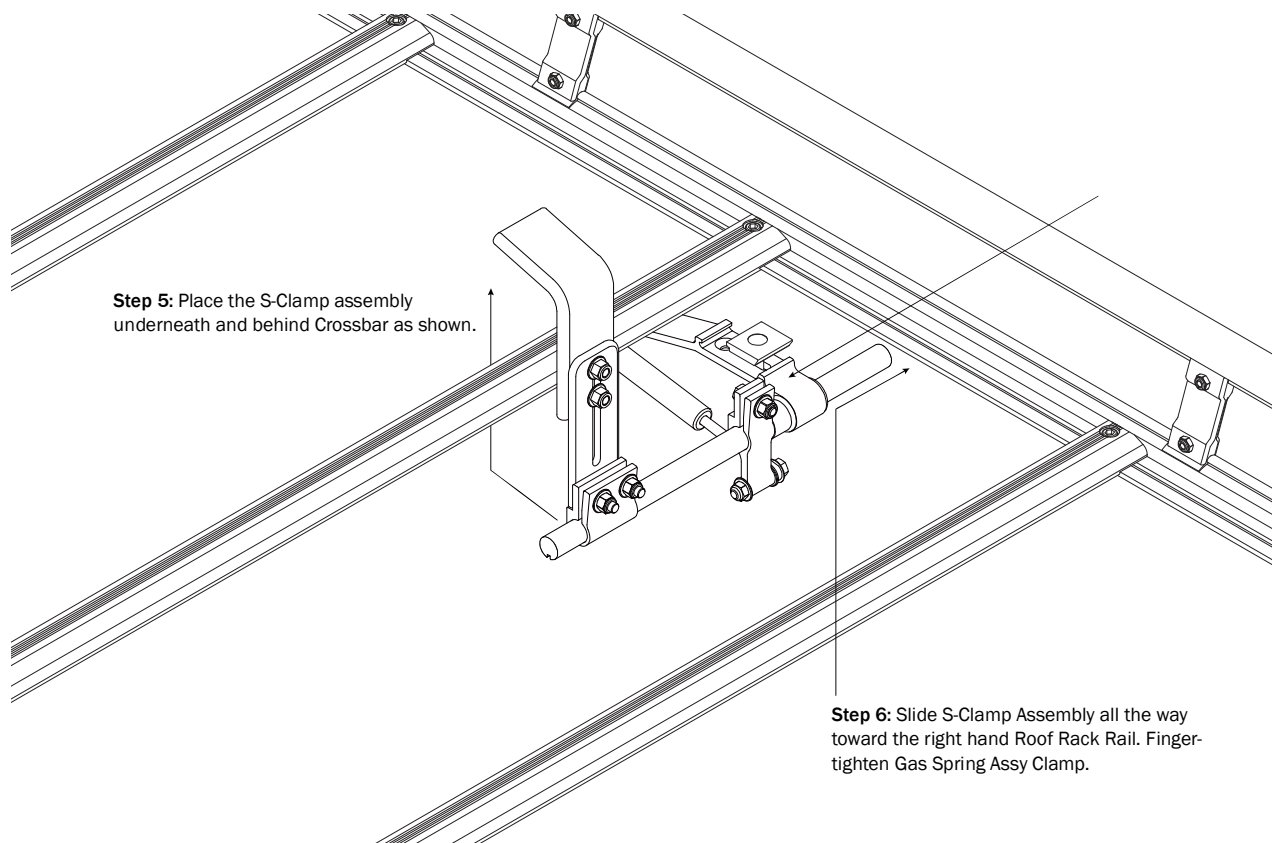

**STEPS 5 –6:**  
**REAR S-CLAMP ASSEMBLY ATTACHMENT**  
**RESULTS**

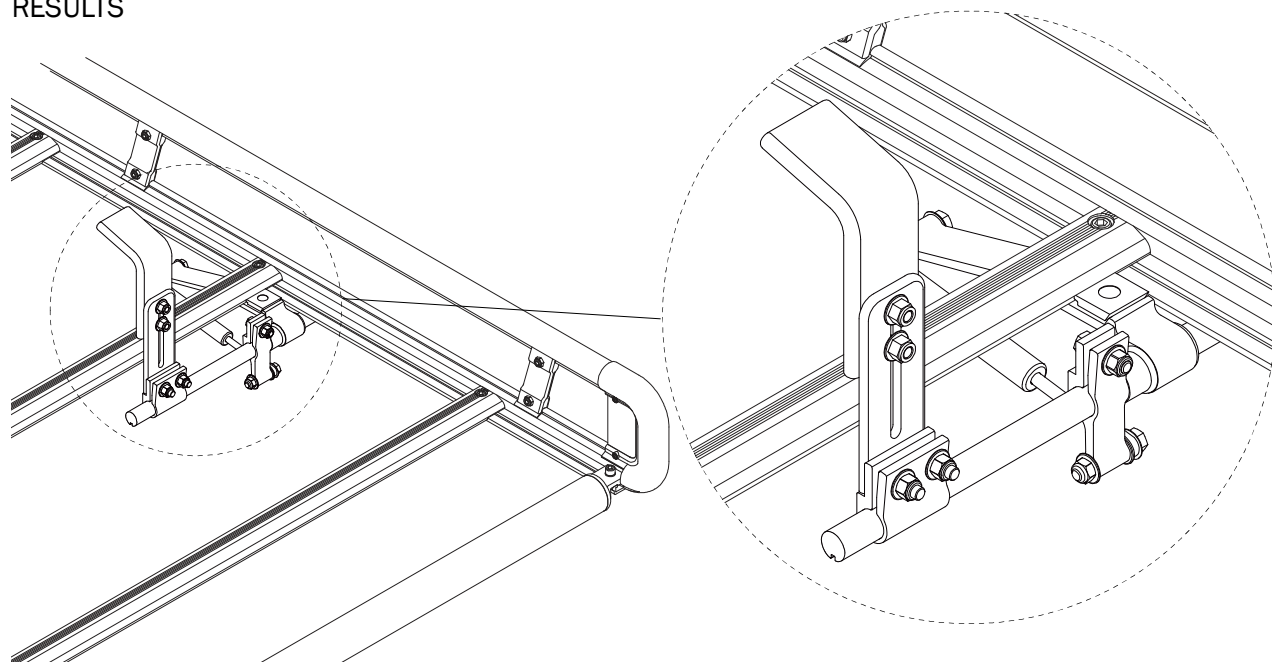



## STEPS 7 –8: INSTALLING THE REAR CLAMP ASSEMBLY

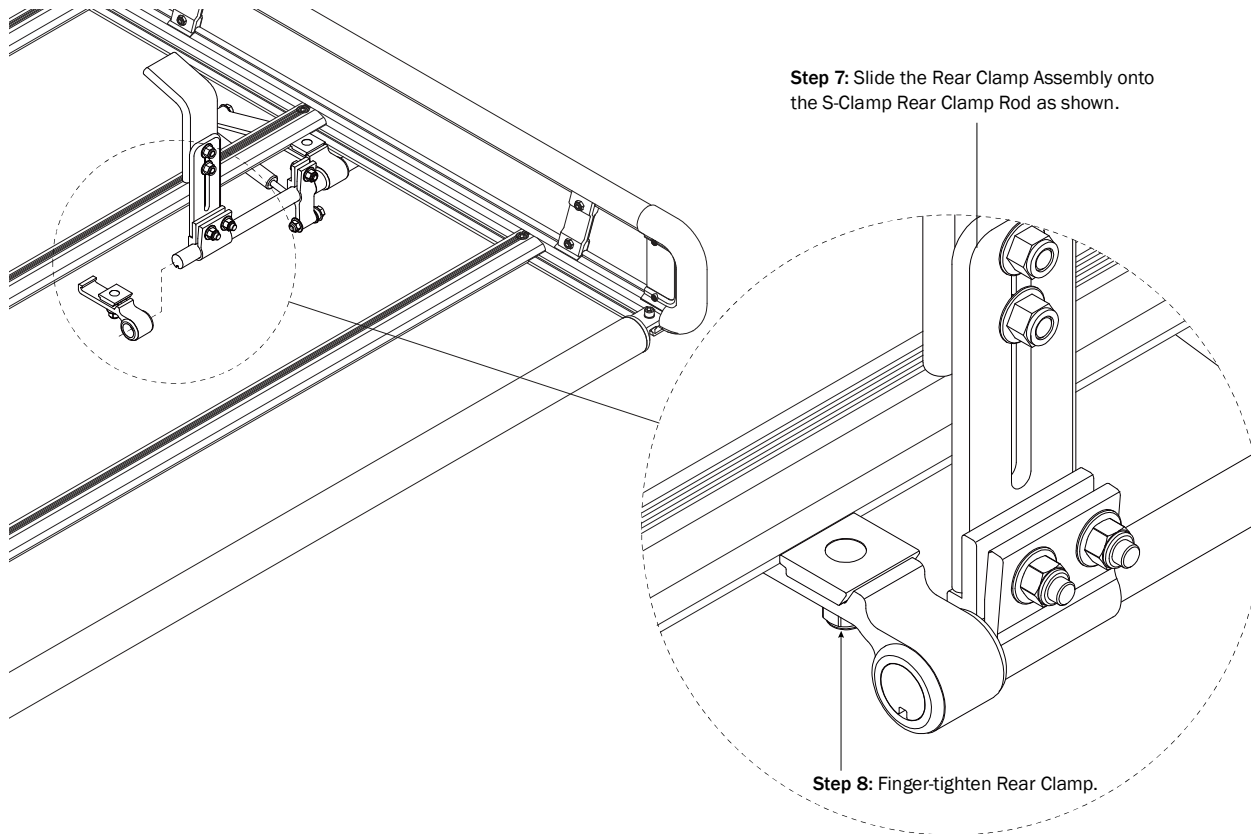

## STEPS 7 –8: REAR CLAMP ASSEMBLY RESULTS

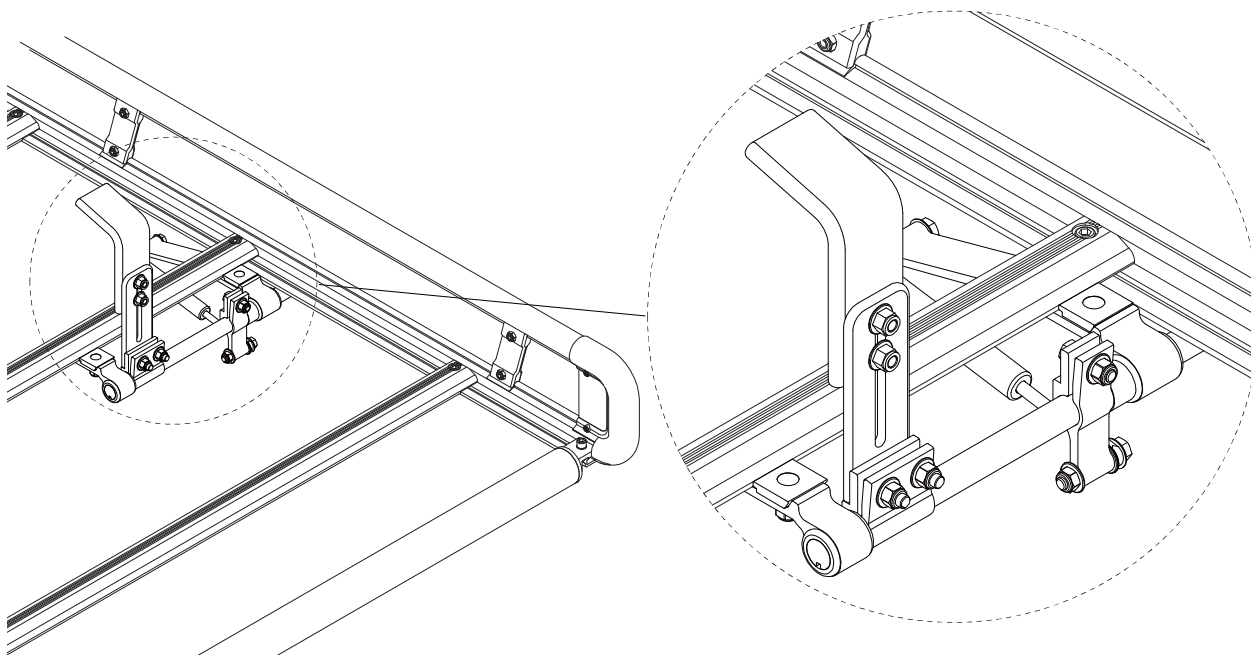

## STEP 9: S-CLAMP HANDLE ASSEMBLY

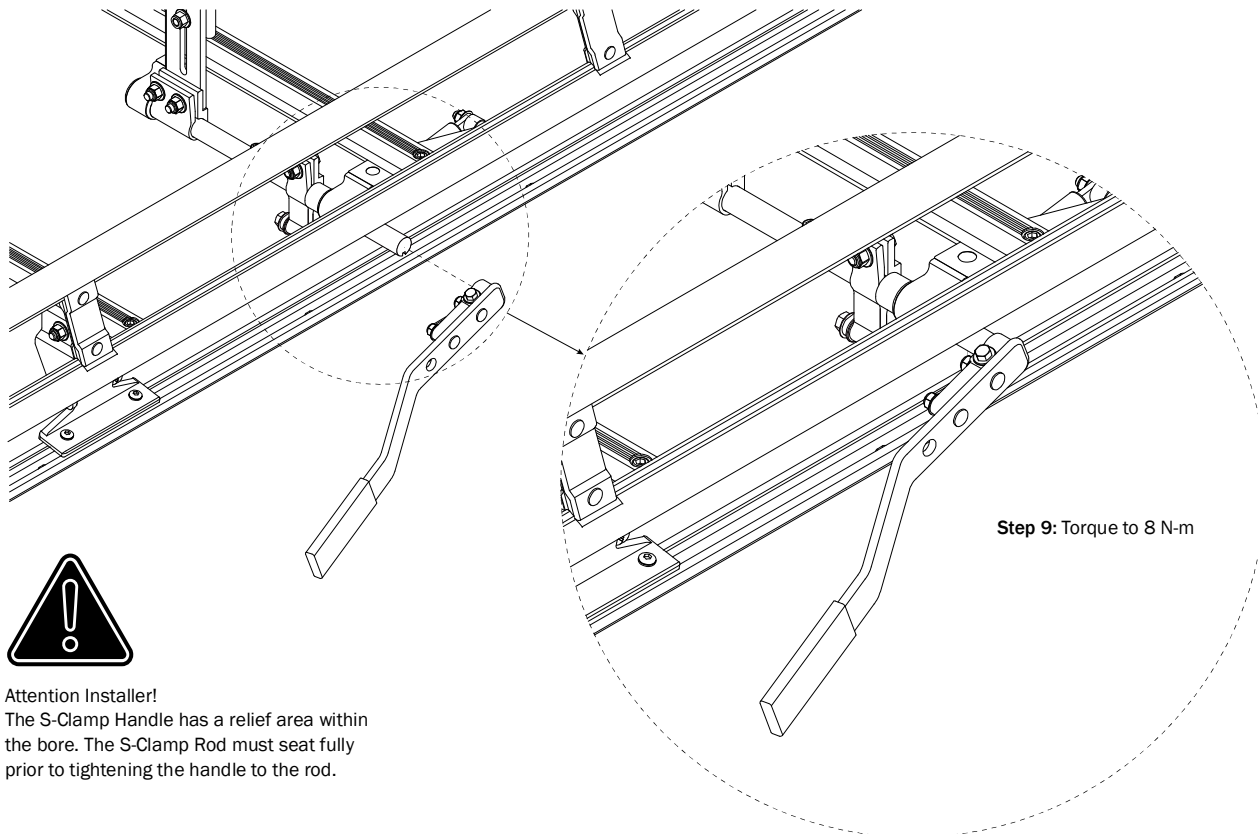

Attention Installer!  
The S-Clamp Handle has a relief area within the bore. The S-Clamp Rod must seat fully prior to tightening the handle to the rod.

## STEP 9: S-CLAMP HANDLE RESULTS

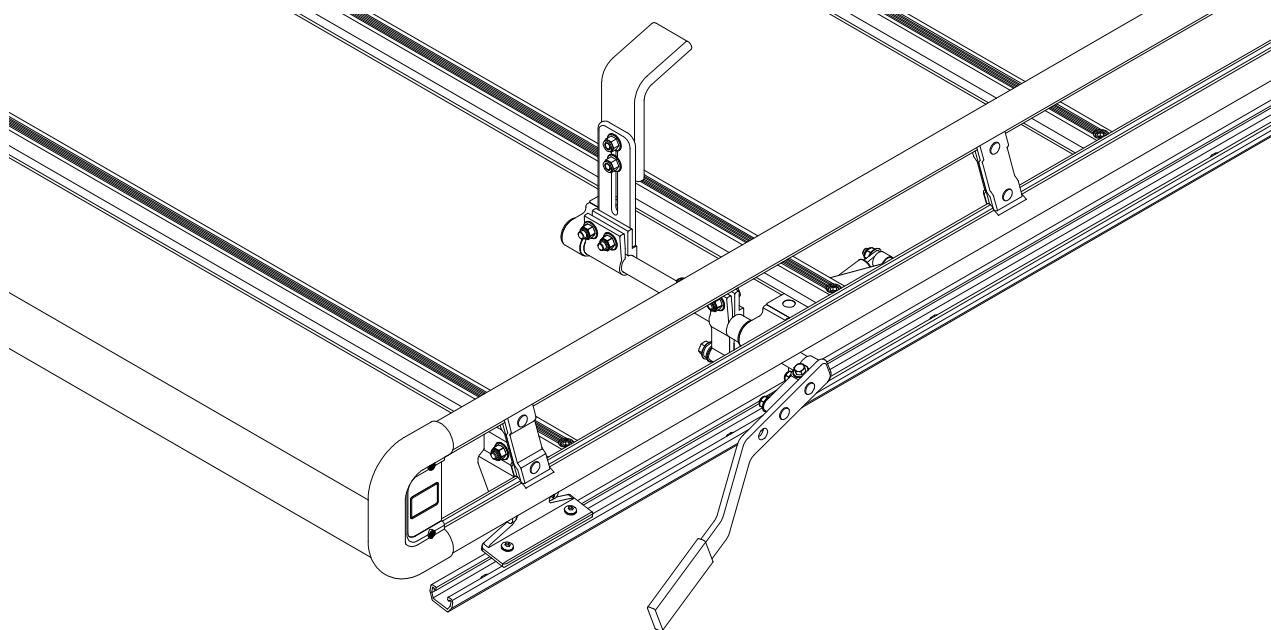

## STEP 10: FINAL REAR S-CLAMP ASSEMBLY TORQUE SPECIFICATIONS

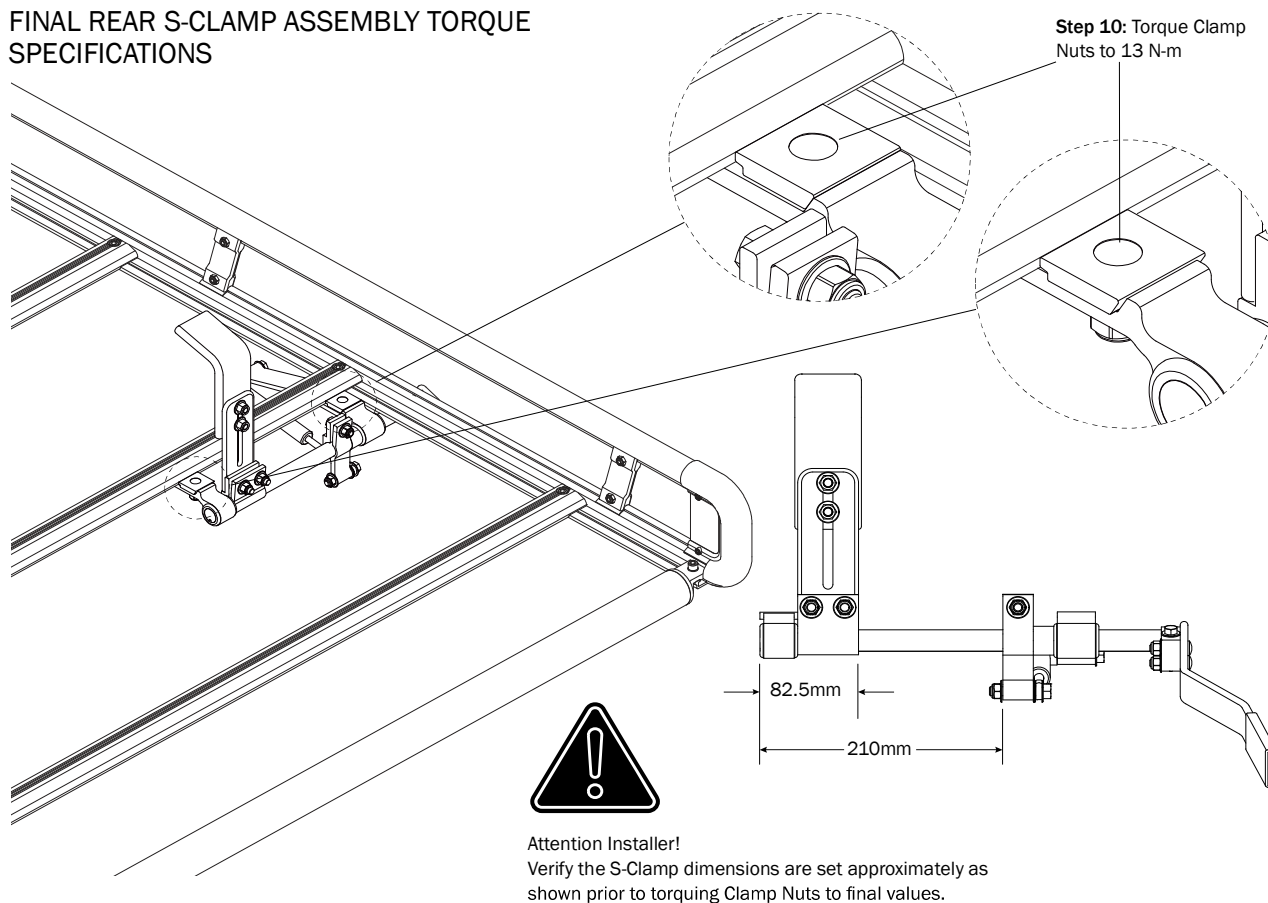

## STEP 10: FINAL REAR S-CLAMP ASSEMBLY RESULTS

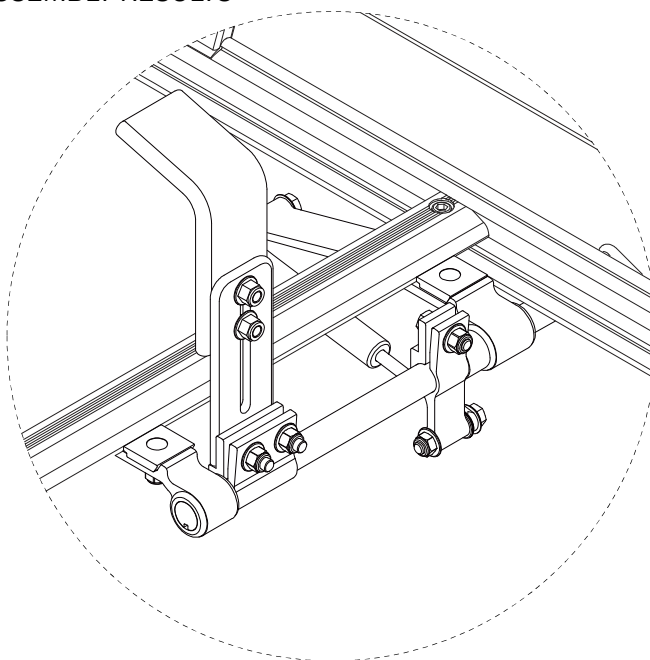

### STEPS 11 –13: INSERTING THE LOCK CLAMP STRIP NUT

**Step 11:** Remove Cap Screws from Rear Roller and applicable Crossbar(s).

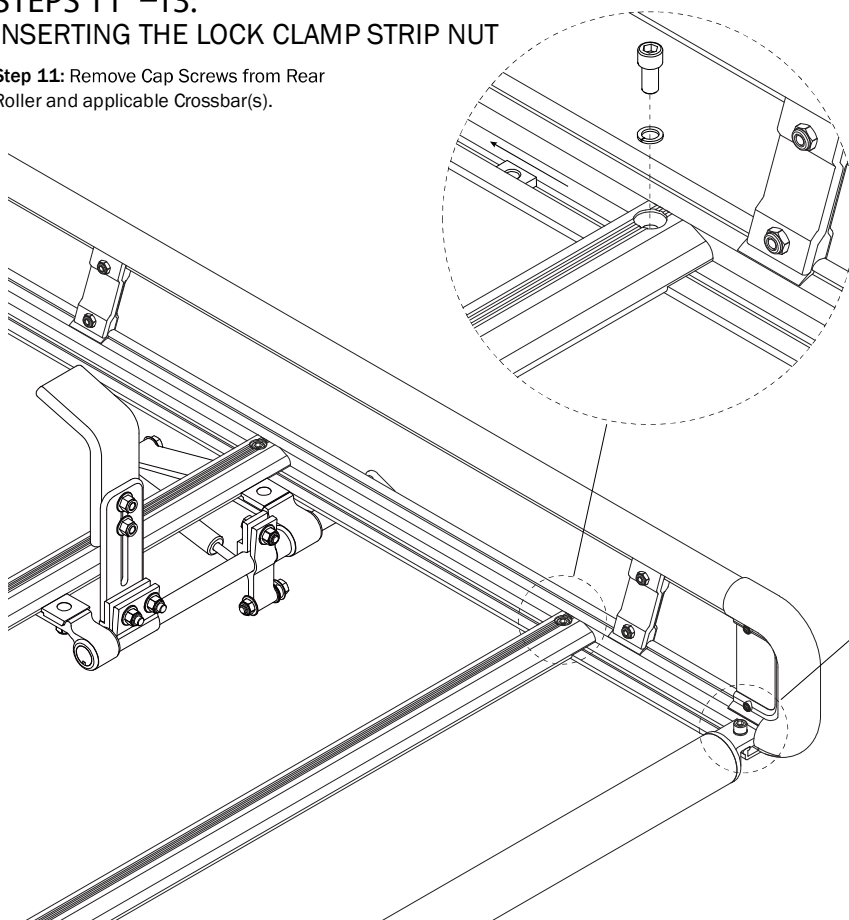

**Step 12:** Slide the new Strip Nut into the Channel and under the Roller Assembly.

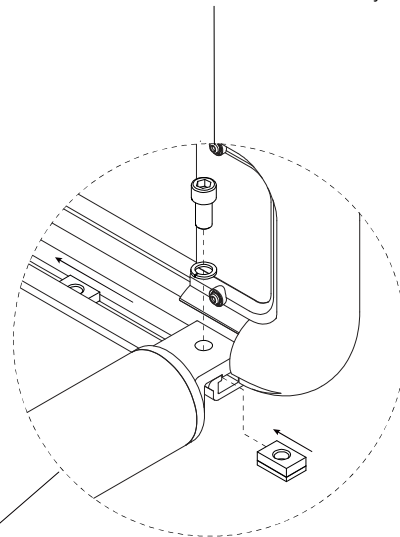

**Step 13:** Advance all loosened Strip Nuts one forward toward the front of the Channel. There will need to be one Strip Nut remaining between the Crossbar immediately behind the mounted S-Clamp Assembly and the Crossbar containing the S-Clamp Assembly.

### STEPS 11 –13: LOCK CLAMP STRIP NUT RESULTS

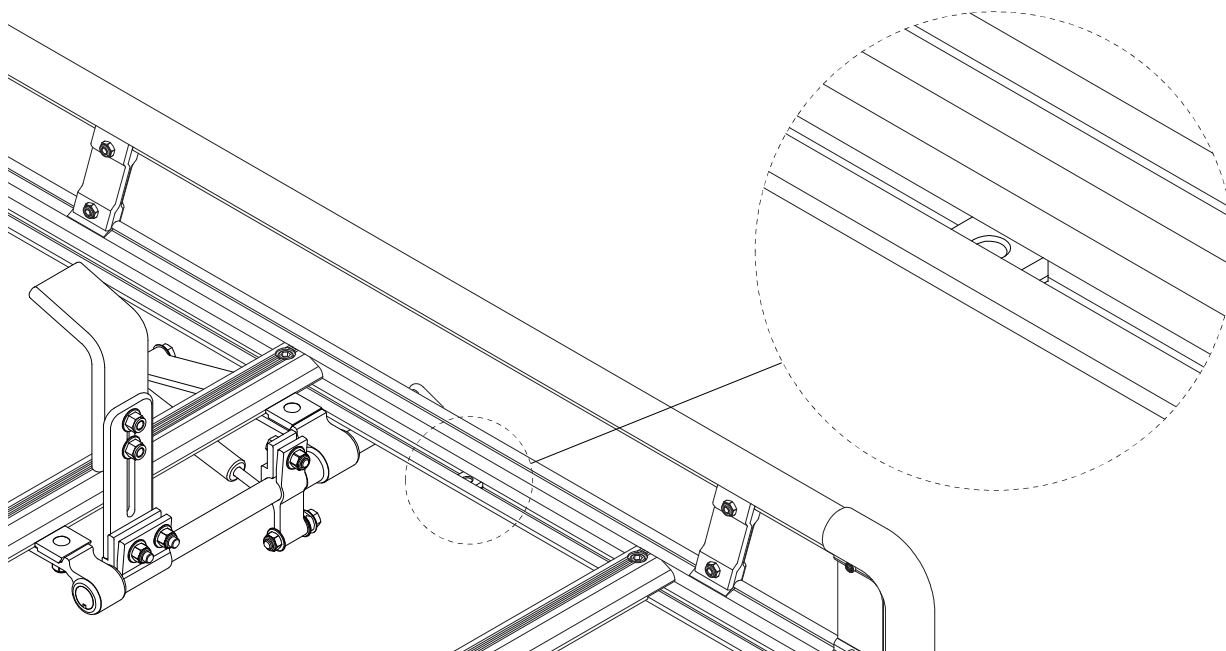

## STEPS 14 –16 INSTALLING THE S-CLAMP HANDLE LOCK CLAMP

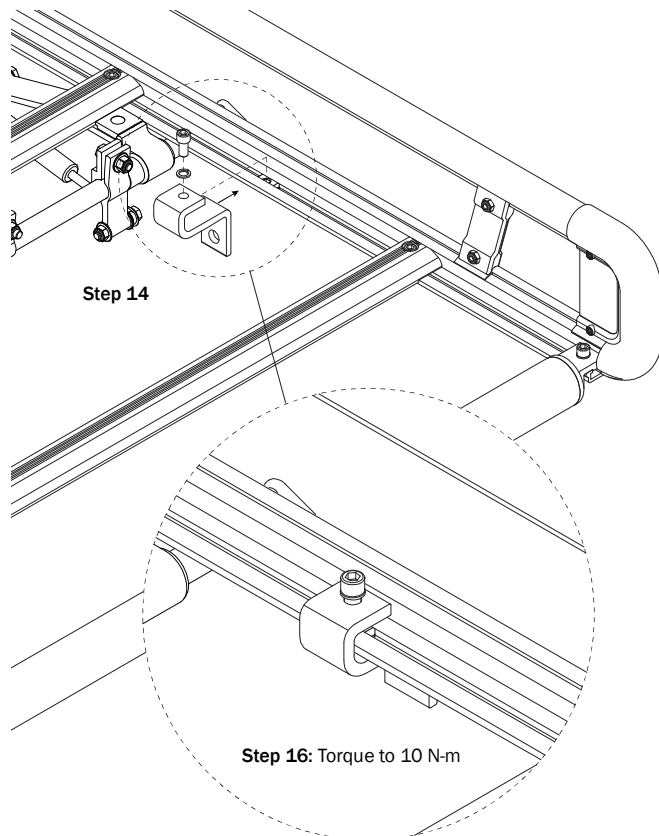

Step 15: Set distances.

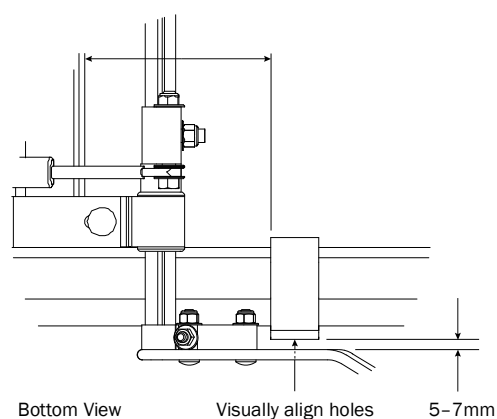

## STEPS 14 –16: S-CLAMP HANDLE LOCK CLAMP RESULTS

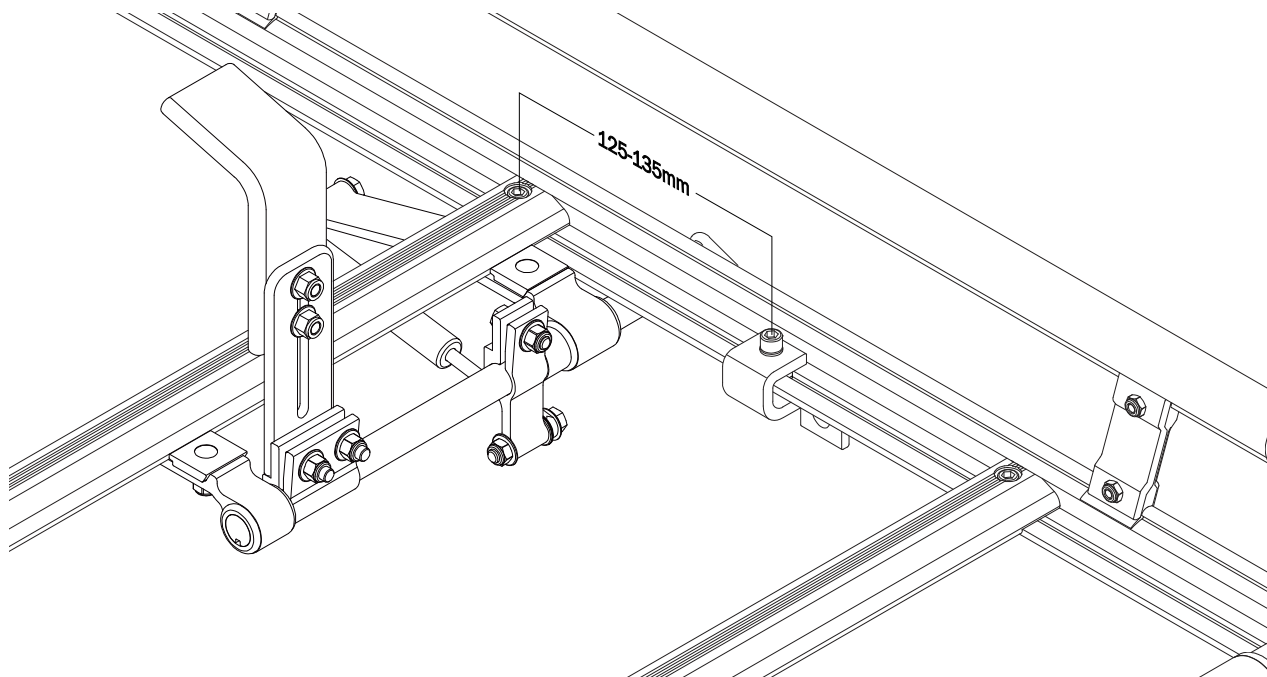

### STEP 17: PREPARING THE FRONT CLAMP ASSEMBLY

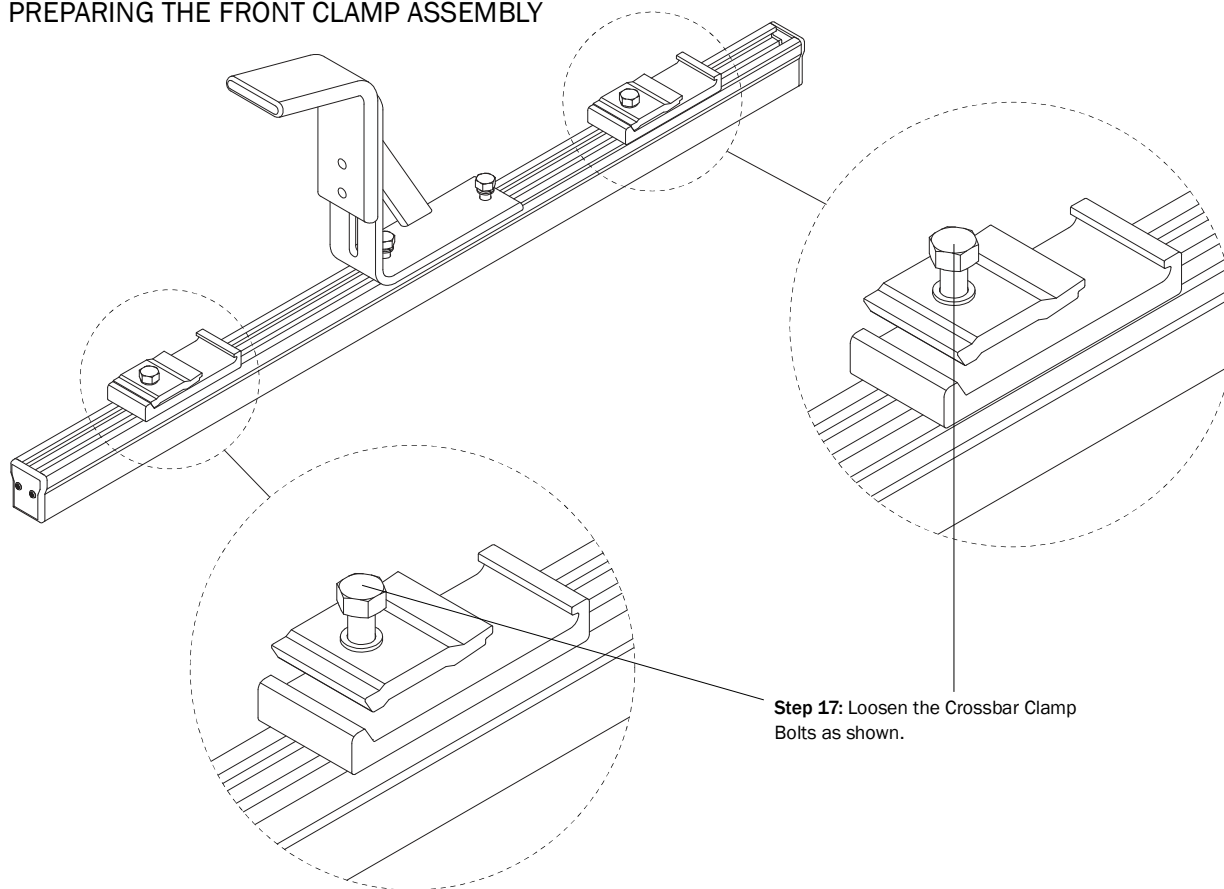

### STEP 17: FRONT CLAMP ASSEMBLY RESULTS

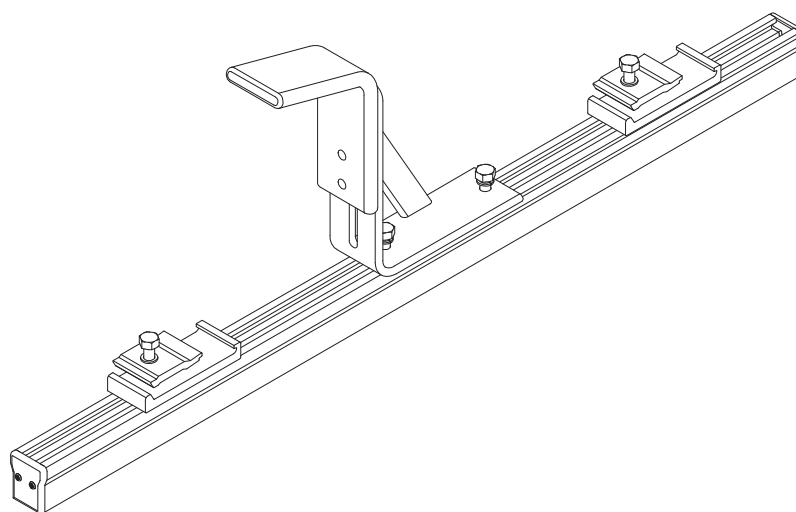

## STEPS 18 –20: INSTALLING THE FRONT CLAMP ASSEMBLY

**Step 18:** Slide Front Clamp Assembly forward until Crossbar Clamp is seated.



Placement of Front Hook Assembly is wholly dependent upon Ladder length and desired clamping location.

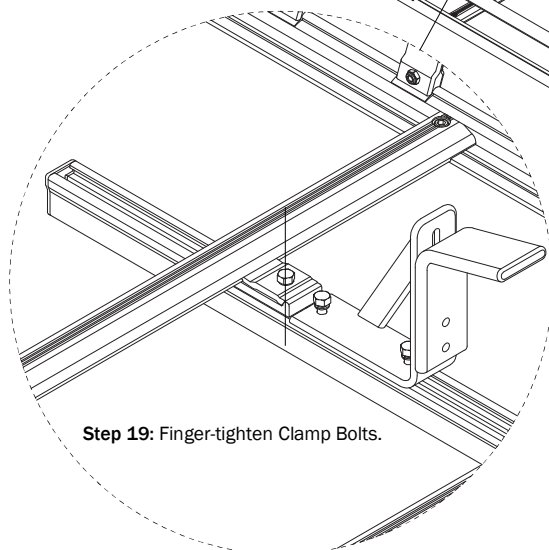
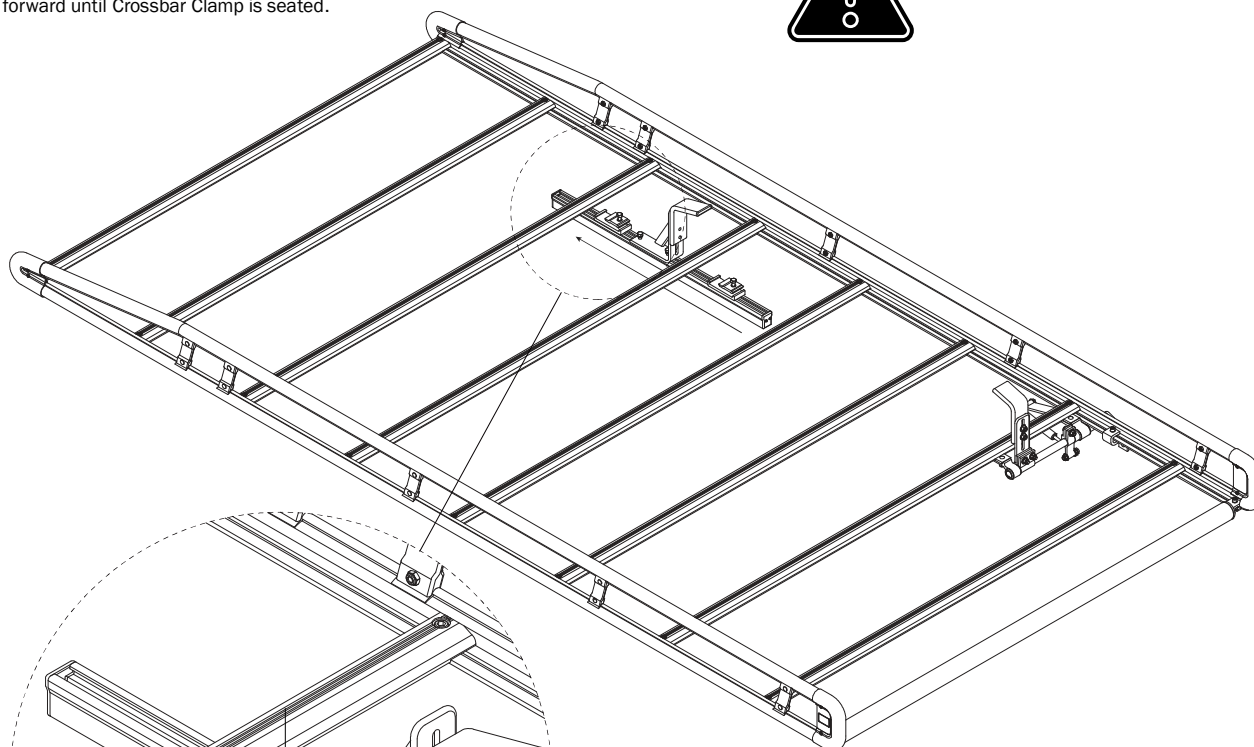

**Step 19:** Finger-tighten Clamp Bolts.

Bottom View

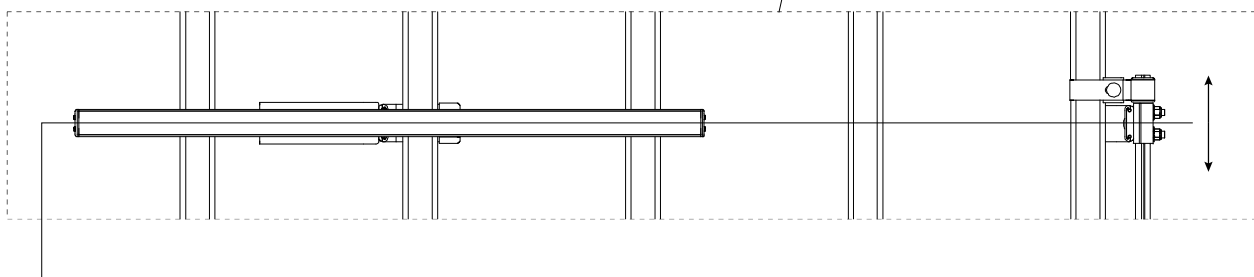
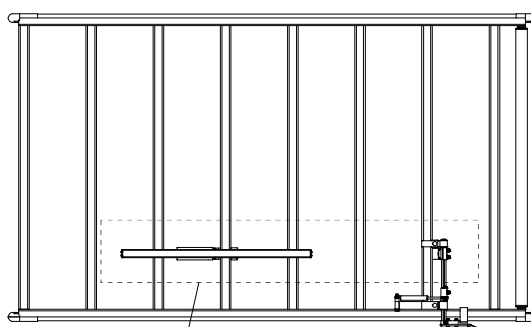

**Step 20:** Align center of Front Hook Assembly to Rear Hook.  
Torque Front Hook Assembly Crossbar Clamps to 13 N-m.



## STEPS 21 –23: ADJUSTING THE FRONT HOOK CLAMP



**Attention End User!**  
Before using the S-Clamp for the first time, it will require adjustments to the Front and Rear Ladder Hooks for correctly securing the ladder to the AluRack.

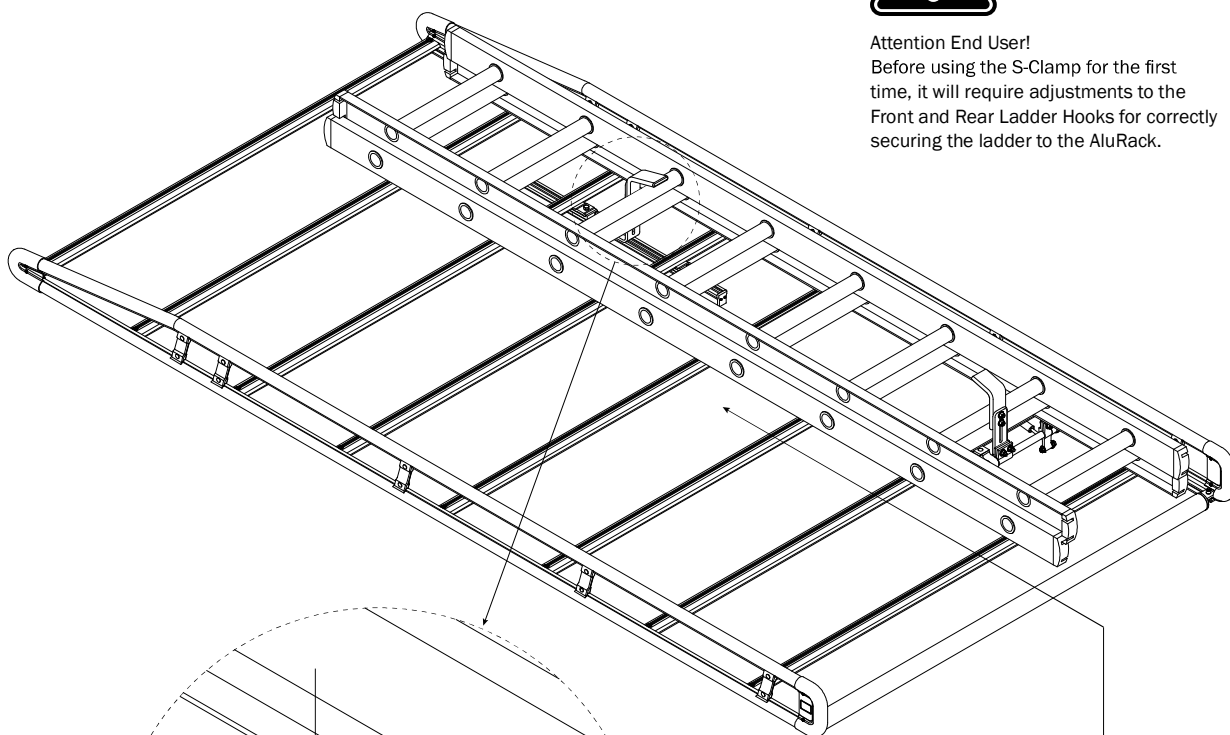

**Step 21:** Push Ladder against the Front Hook as shown.

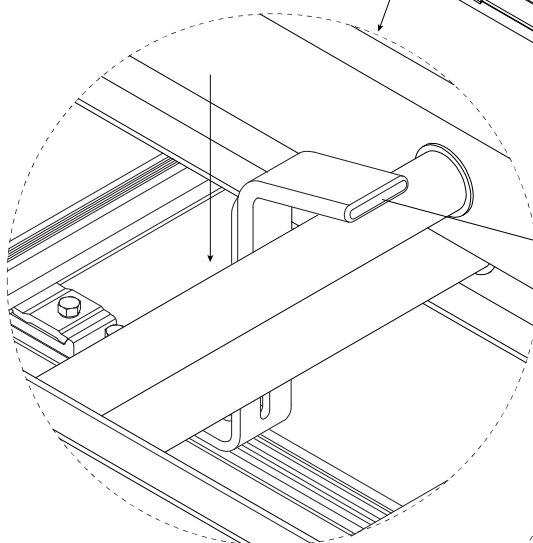

**Step 22:** Push Front Hook downward against Ladder Rung until snug as shown.

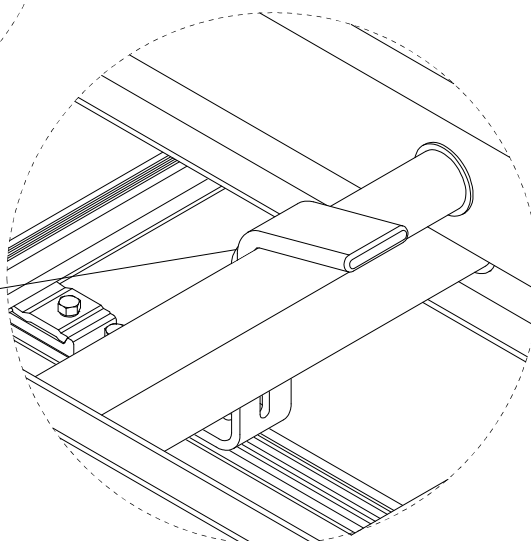

**Step 23:** Torque Front Ladder Hook to 13 N-m.



## STEPS 24 –25: ADJUSTING THE REAR HOOK CLAMP

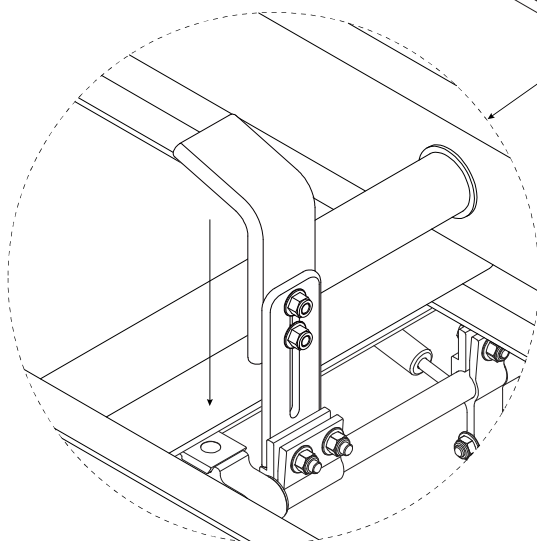
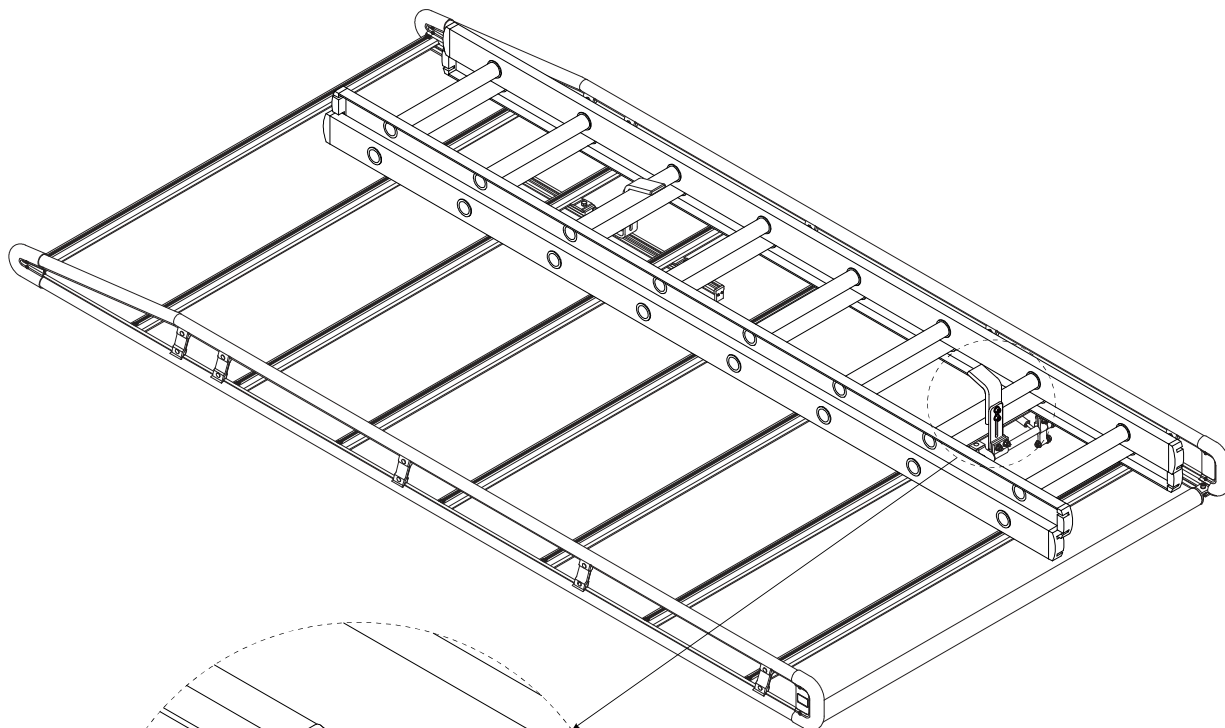

**Step 24:** Push Rear Hook downward against Ladder Rung until snug as shown.

**Step 25:** Torque Rear Ladder Hook to 13 N-m.



When adjusted properly, Rear Clamp is vertical and Padlock holes line up between Handle and Bracket. If Padlock holes are not aligning, check that the Handle is firmly seated on the Rear Hook Assembly Rod, and the S-Clamp Handle Lock Clamp is properly set according to Steps 14-16 of this Assembly Manual.

